



Branford Price Millar Library, Portland State University

1966, addition: SOM, 1989
 150,000 sq. ft., 1.4 million volumes
 18,900 journal subscriptions
 PSU staff (2008): 25 librarians,
 45 classified staff,
 74 student hourly workers



PSU's existing library is a forced marriage of two disparate styles and intentions. The original, Brutalist library faced SW 10th Ave., which is now the rear of the building and is comprised primarily of stacks. The new addition and façade, facing the South Park Blocks, gather students in a central curve wrapping around a heritage Copper Beech tree, planted about 1890. While providing study groups and individual students with an excellent gathering space, and some eye-catching visual effects, the curtain wall façade pinches the circulation desk, central stairs and computer lab, which are cramped and uninspiring.

PSU Enrollment, 2009: **26,587**
 Projected enrollment, 2012: **35,000**

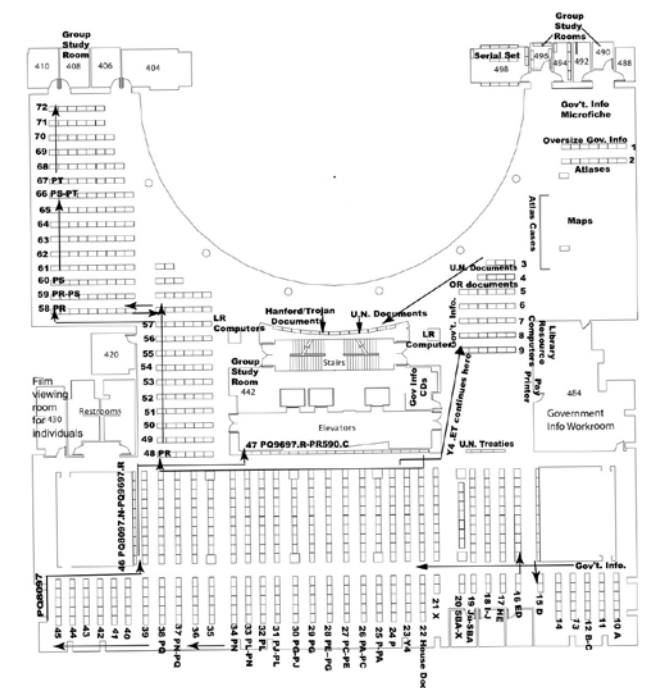

Circulation is compartmentalized and complicates wayfinding.



This former copy area was recently walled off to add space to meet increasing activity of interlibrary loans.



Precedents

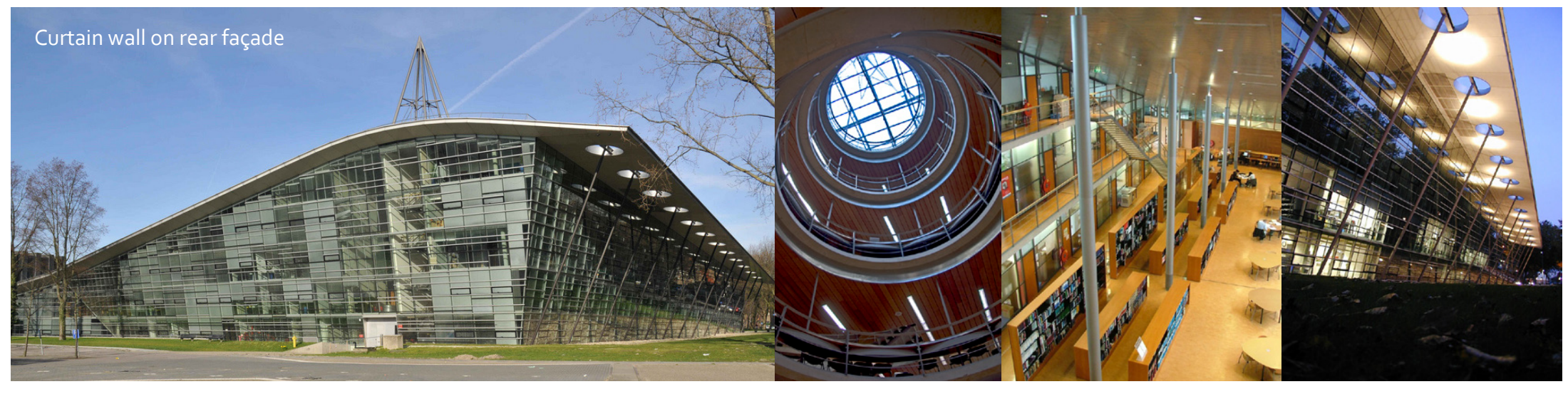

Curtain wall on rear façade

Delft University of Technology Library, Netherlands

Mecanoo Architecten/Francine Houben 1993-1998
 161,500 sq. ft.
 80,000 volumes above ground

First floor plan Longitudinal section

Cone of reading rooms doubles as light well and ceiling for circulation desk

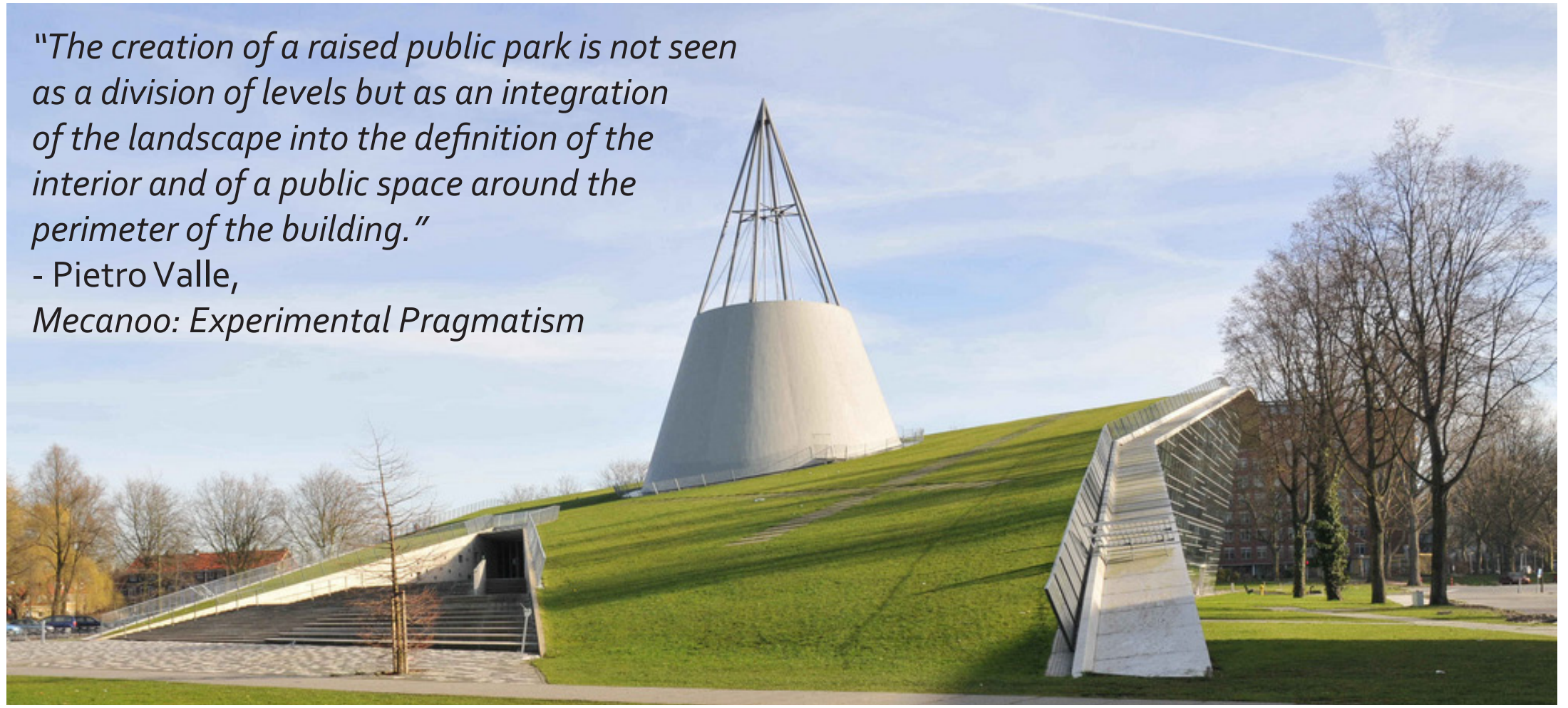

"The creation of a raised public park is not seen as a division of levels but as an integration of the landscape into the definition of the interior and of a public space around the perimeter of the building."
 - Pietro Valle,
 Mecanoo: Experimental Pragmatism

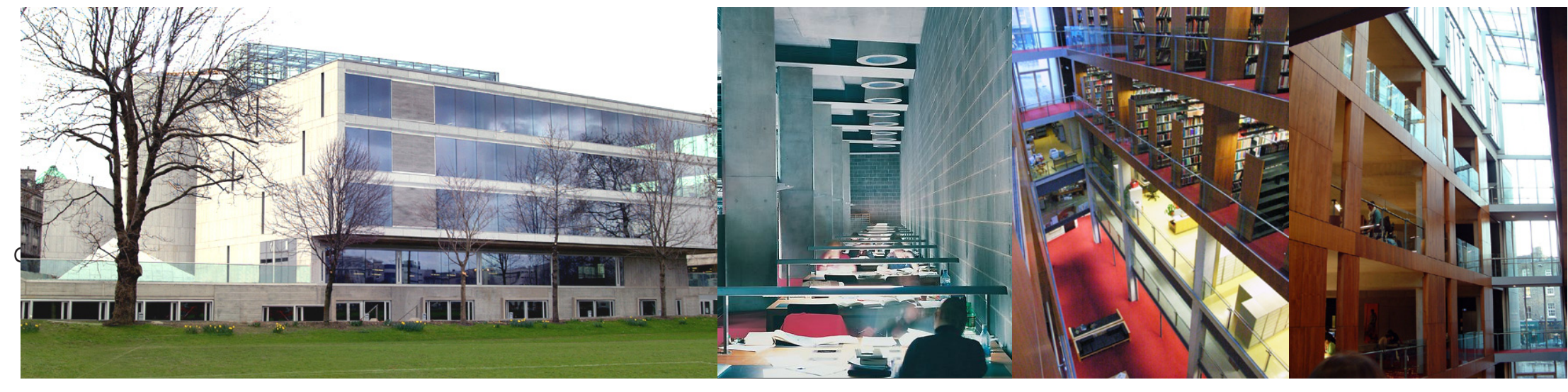

The James Ussher Library, Trinity College, Dublin

McCullough Mulvin/Keane Murphy Duff, 1999-2002,
 108,000 sq. ft., 350,000 volumes

Plan Longitudinal section

"Three sculptural blocks on a podium sit north-south across the site. The two longer blocks are connected by an atrium. The taller is closed and stone-clad and dedicated to book storage (a tower of books); the lower, more dynamically shaped in stone and glass contains reading rooms with views over College Park; the third block is for a Book Conservation Laboratory.
Each block is served by a core at one end which anchors the plan. The new building forms a functional unit with the existing Berkeley and Lecky libraries. The building is like a gateway — three books forming open space between them, framing views and routes from the city into the College."
 - Architectural Record



University Library UBU, Utrecht, Netherlands

Wiel Arets Architects, 1997-2004
 409,000 sq. ft., 3.1 million volumes

Plan Longitudinal section

"[The library] is more than a place where people can consult books. It is a place where they can work in a concentrated fashion. The book depots, which seem to float, divide the space into zones and are interconnected by stairs and slopes. Based on the idea that silent communication is important in a building where there is hardly any talking, the atmosphere is determined with an emphasis on creating a sense of security."
 - Wiel Arets





Urban plaza panorama



Urban Center



New Rec Center

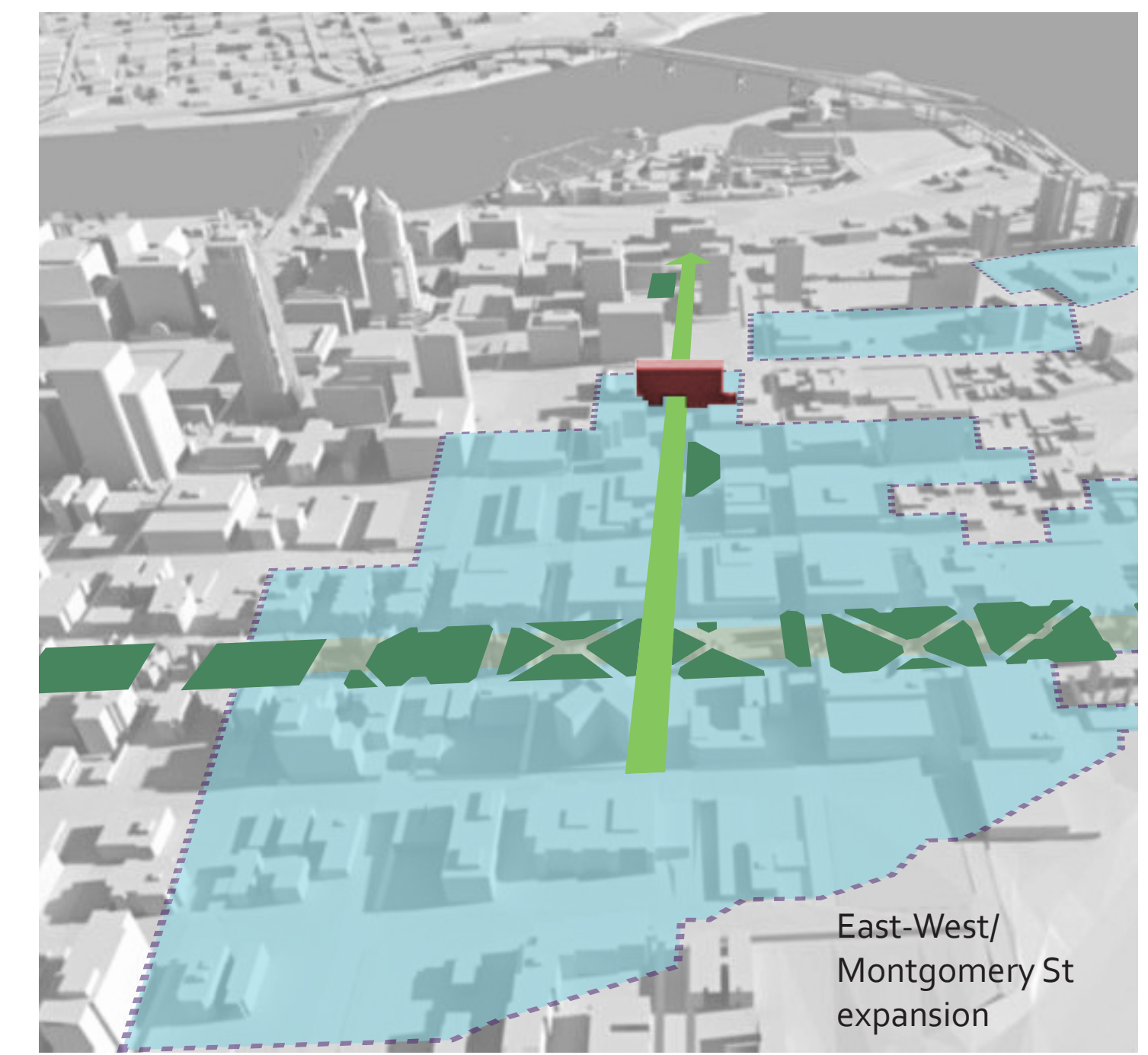

East-West/
Montgomery St
expansion

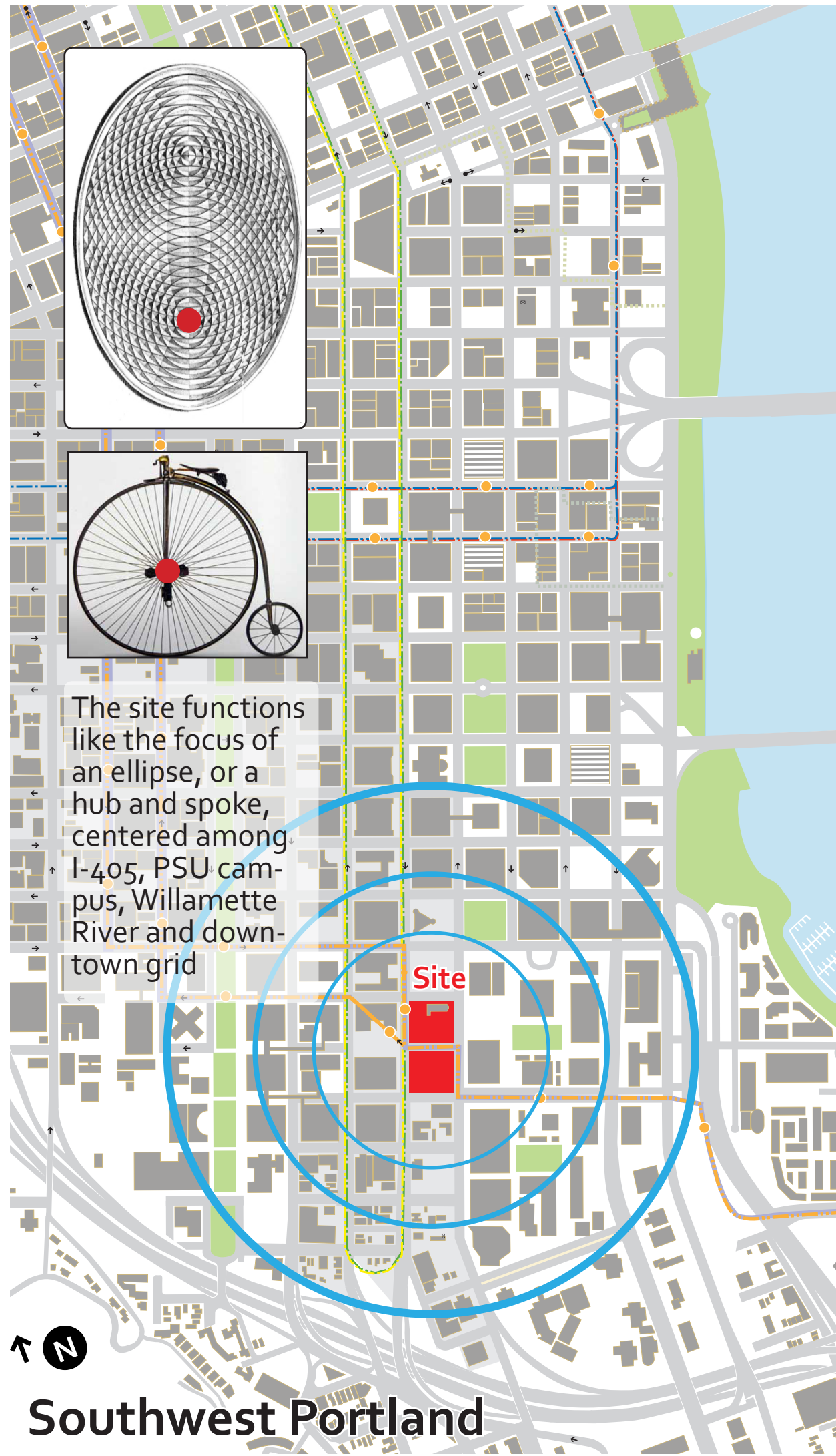

The site functions like the focus of an ellipse, or a hub and spoke, centered among I-405, PSU campus, Willamette River and downtown grid

Southwest Portland

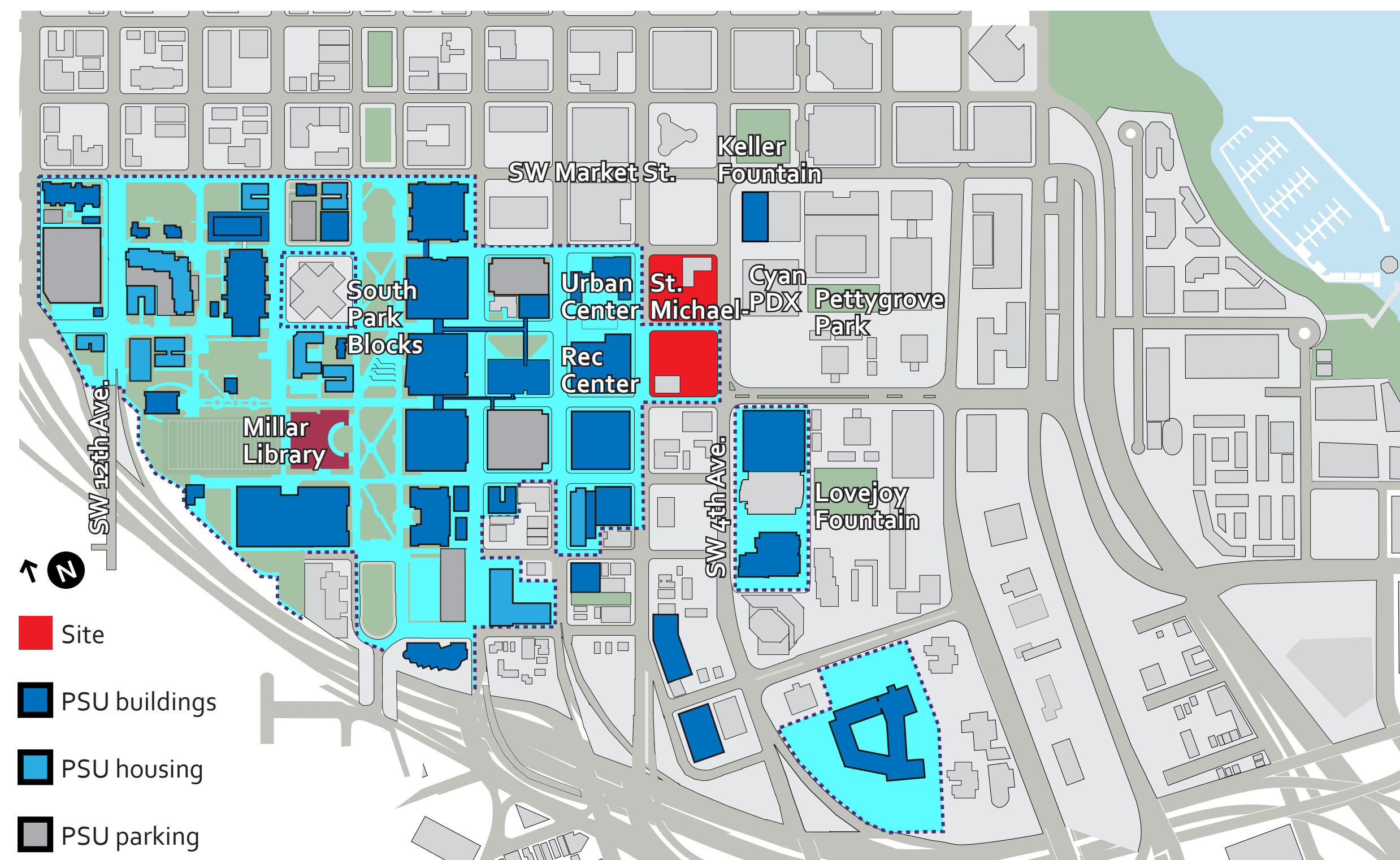

- Site
- PSU buildings
- PSU housing
- PSU parking
- PSU campus

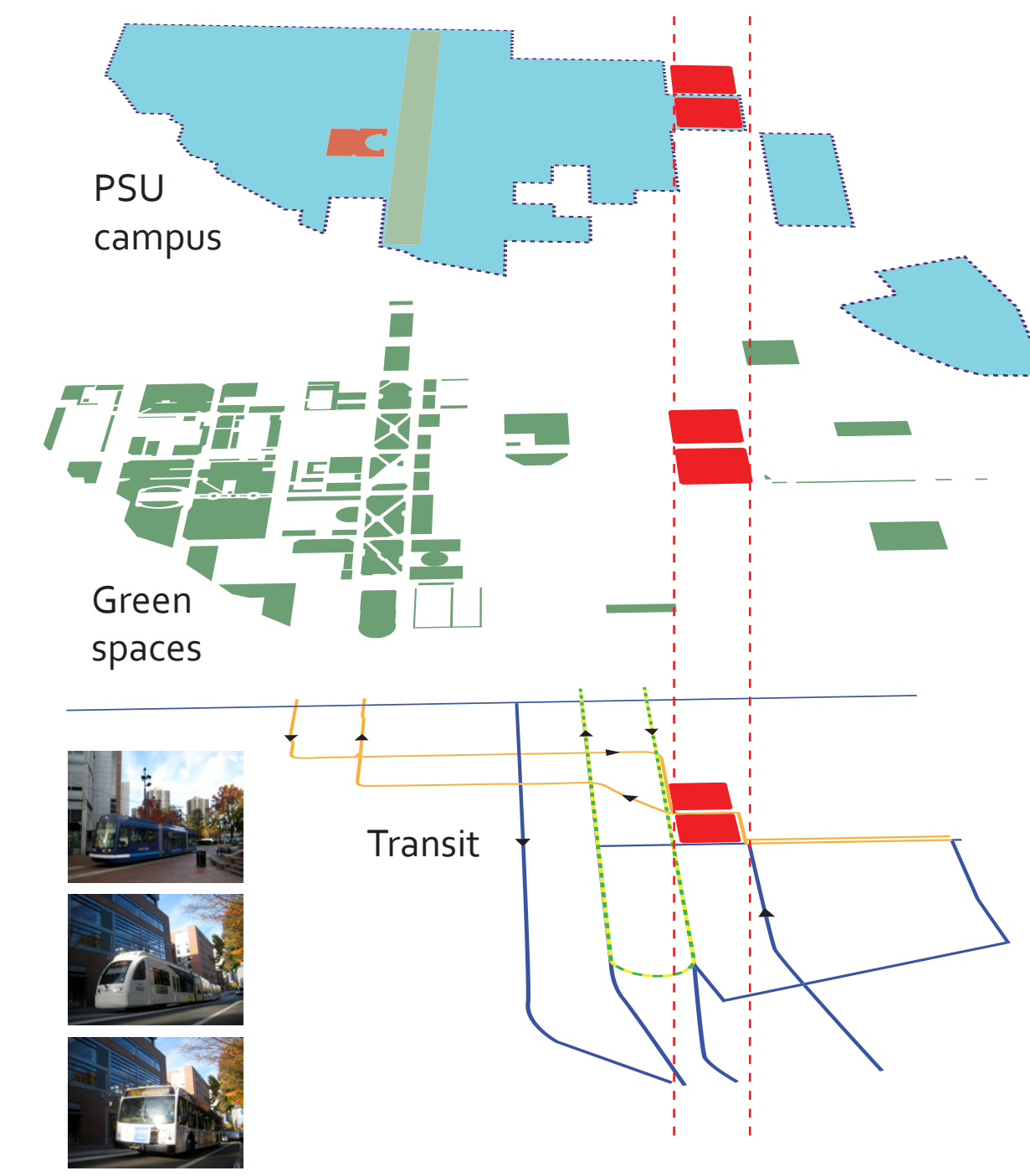

Transit

Site

Montgomery St. sequence



Open space sequence concepts

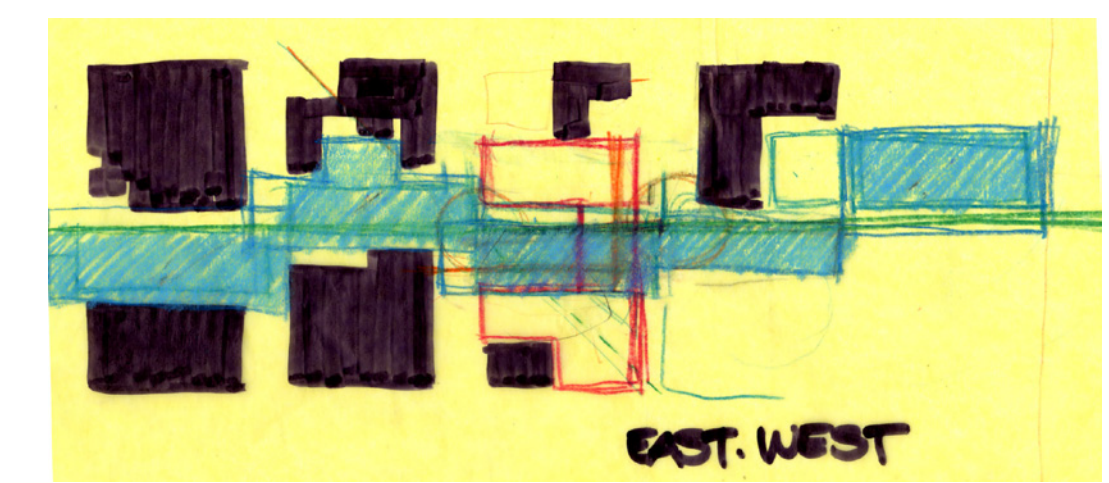
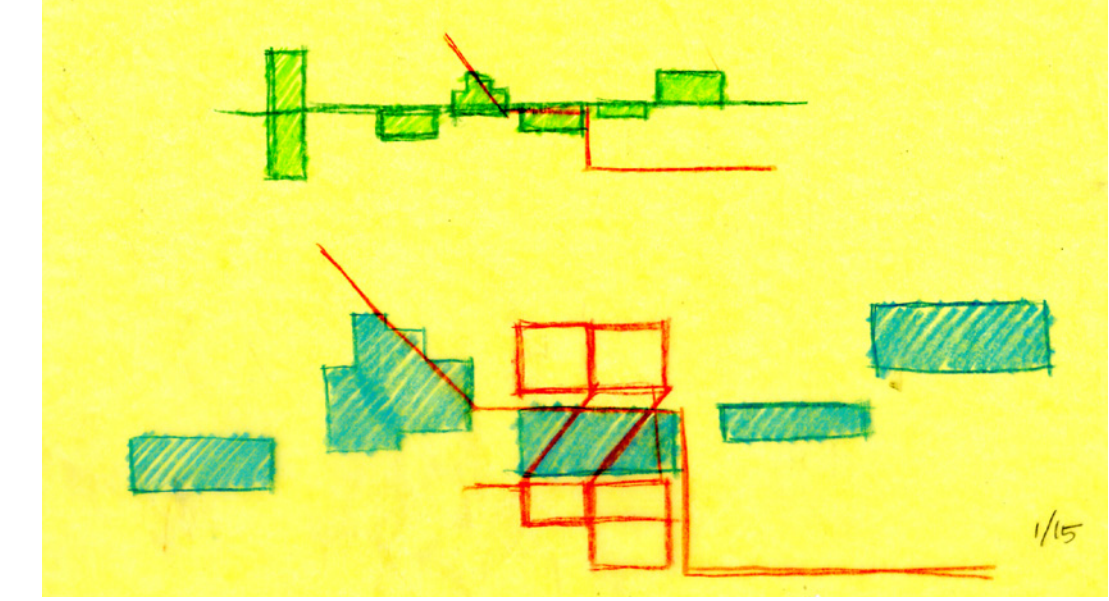

Site context buildings

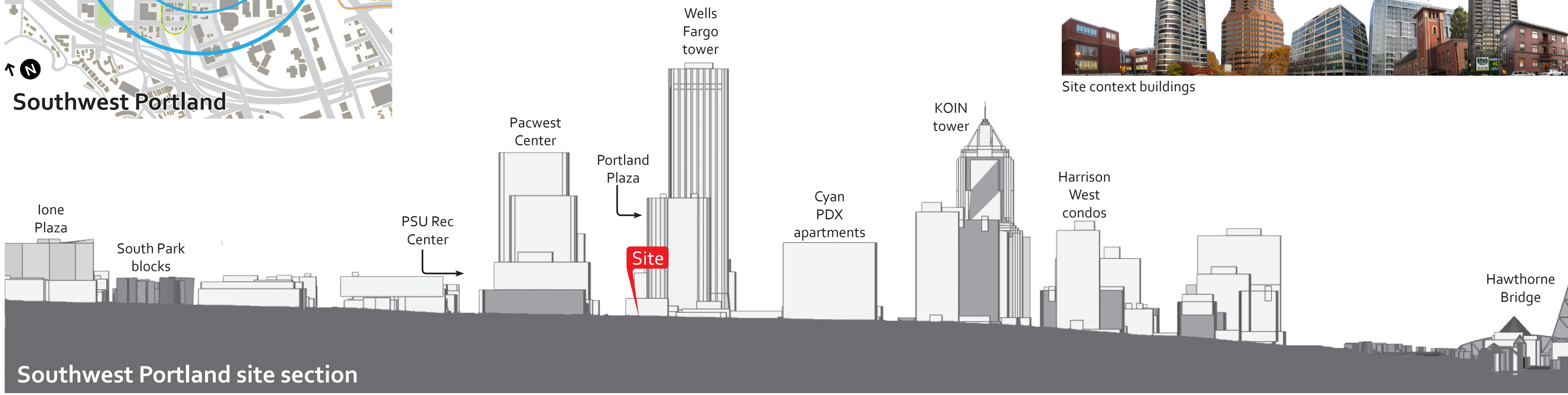

Southwest Portland site section



Panorama from SW 4th St.



Panorama from SW 5th St.



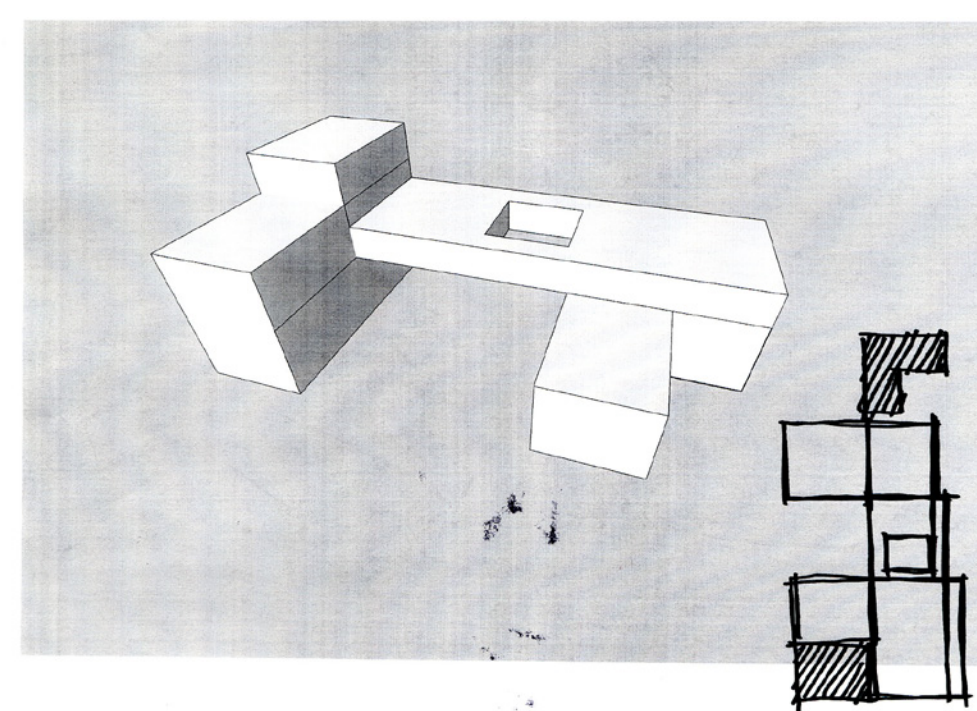
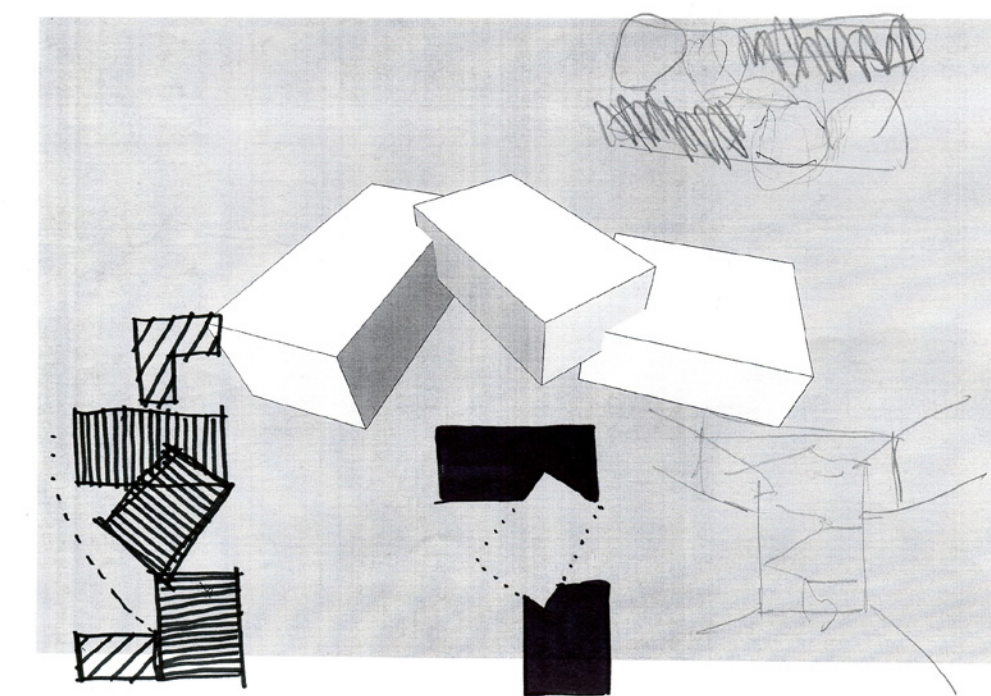
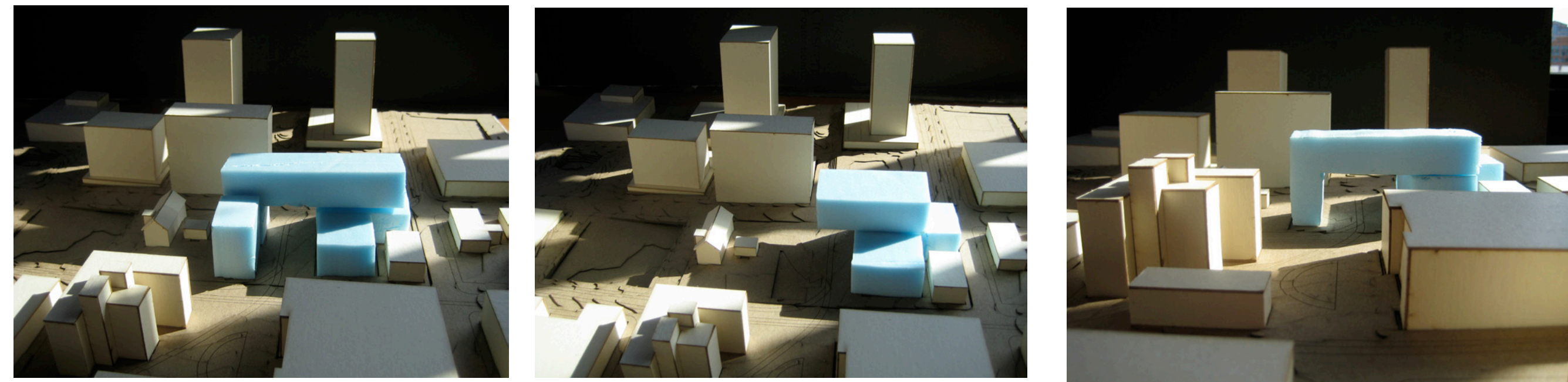
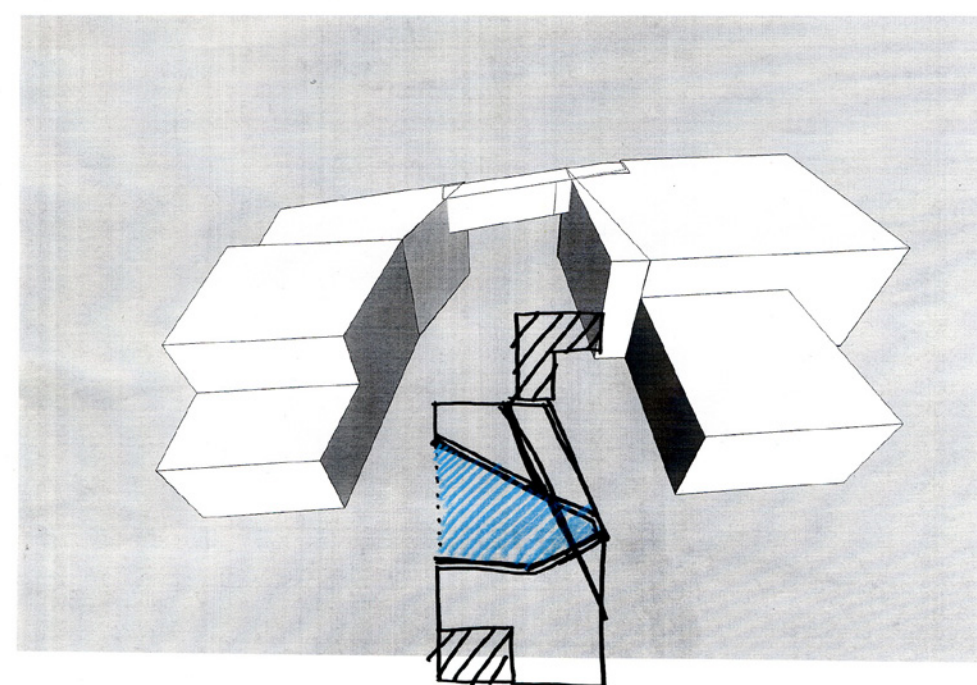
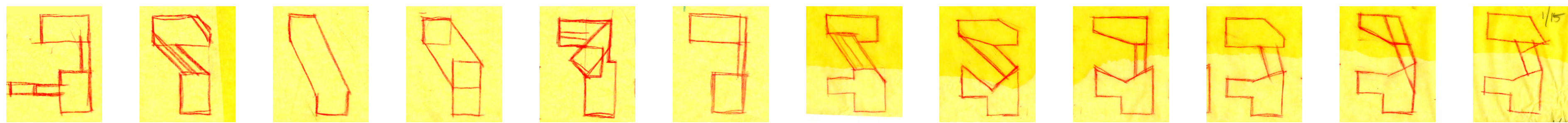

The massing above the existing streetcar line creates a gateway between downtown and the expanding PSU campus, as well as responding to the SW Montgomery pedestrian green street proposal and the urban plaza across the street. Programmatically the massing separates the traditional media, digital media and service and social functions of the library.

Early schemes

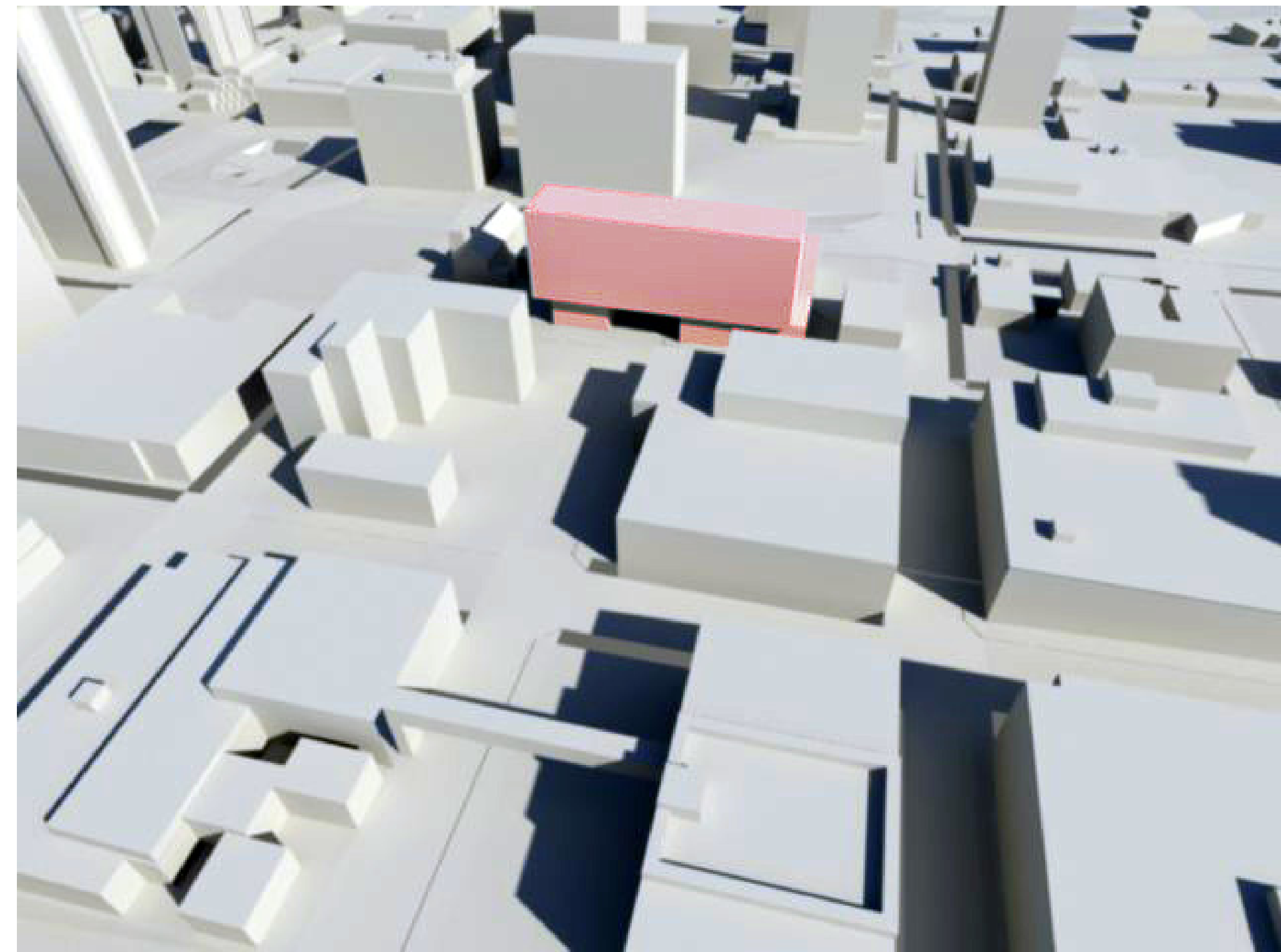

Programming study 1/64" = 1'0"

- Traditional media
- Administrative
- Computer/digital media
- Social space

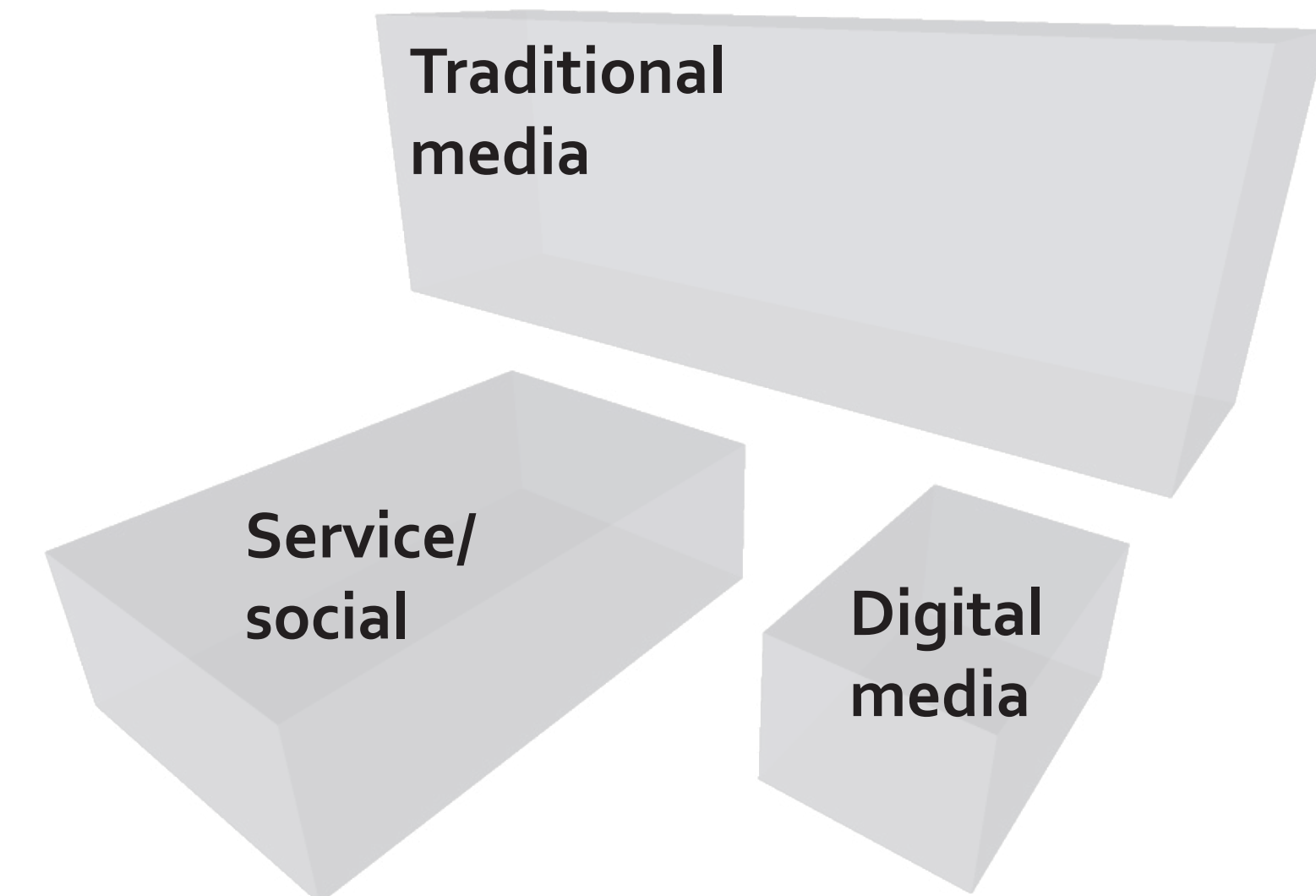

Massing

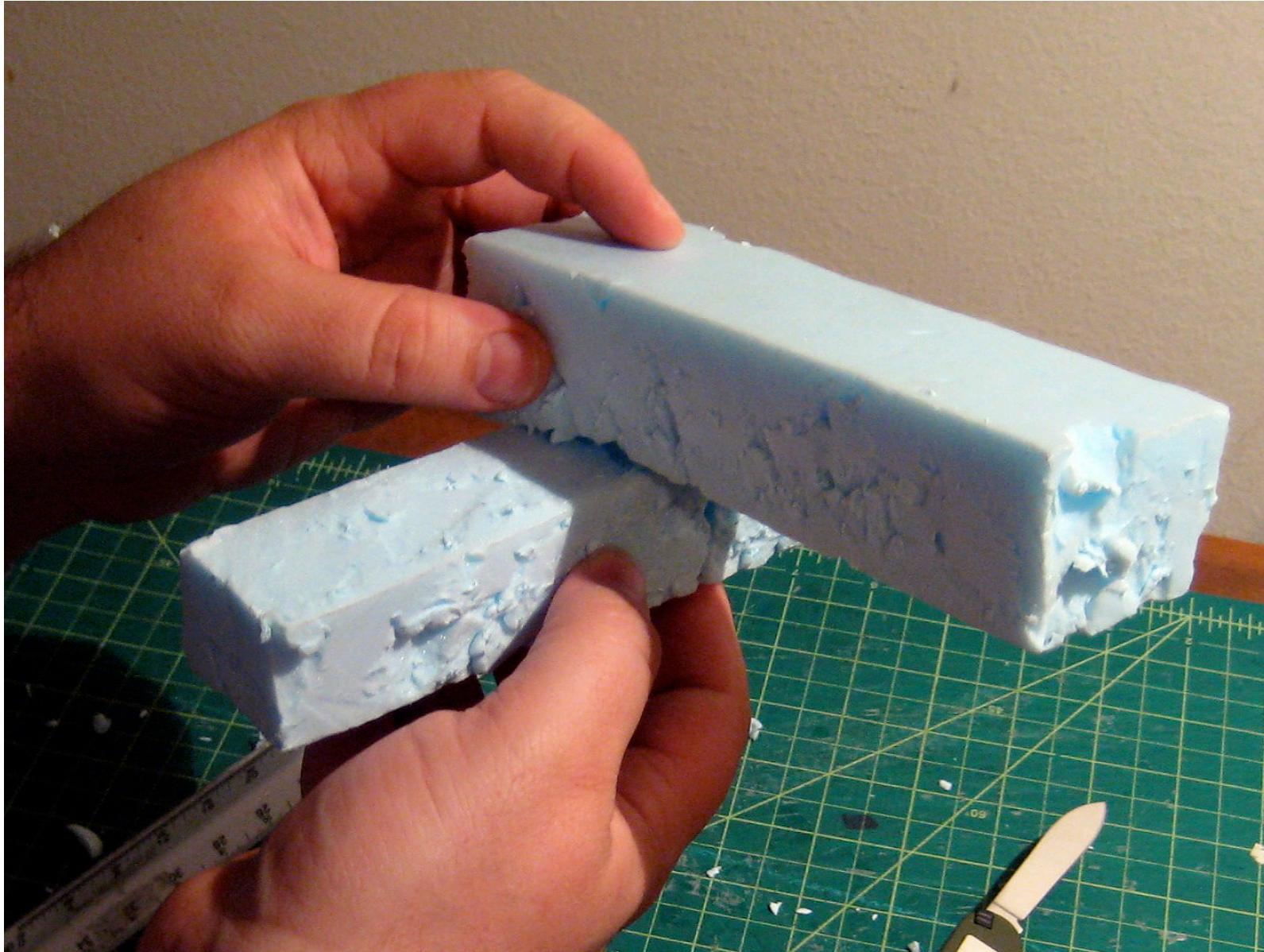
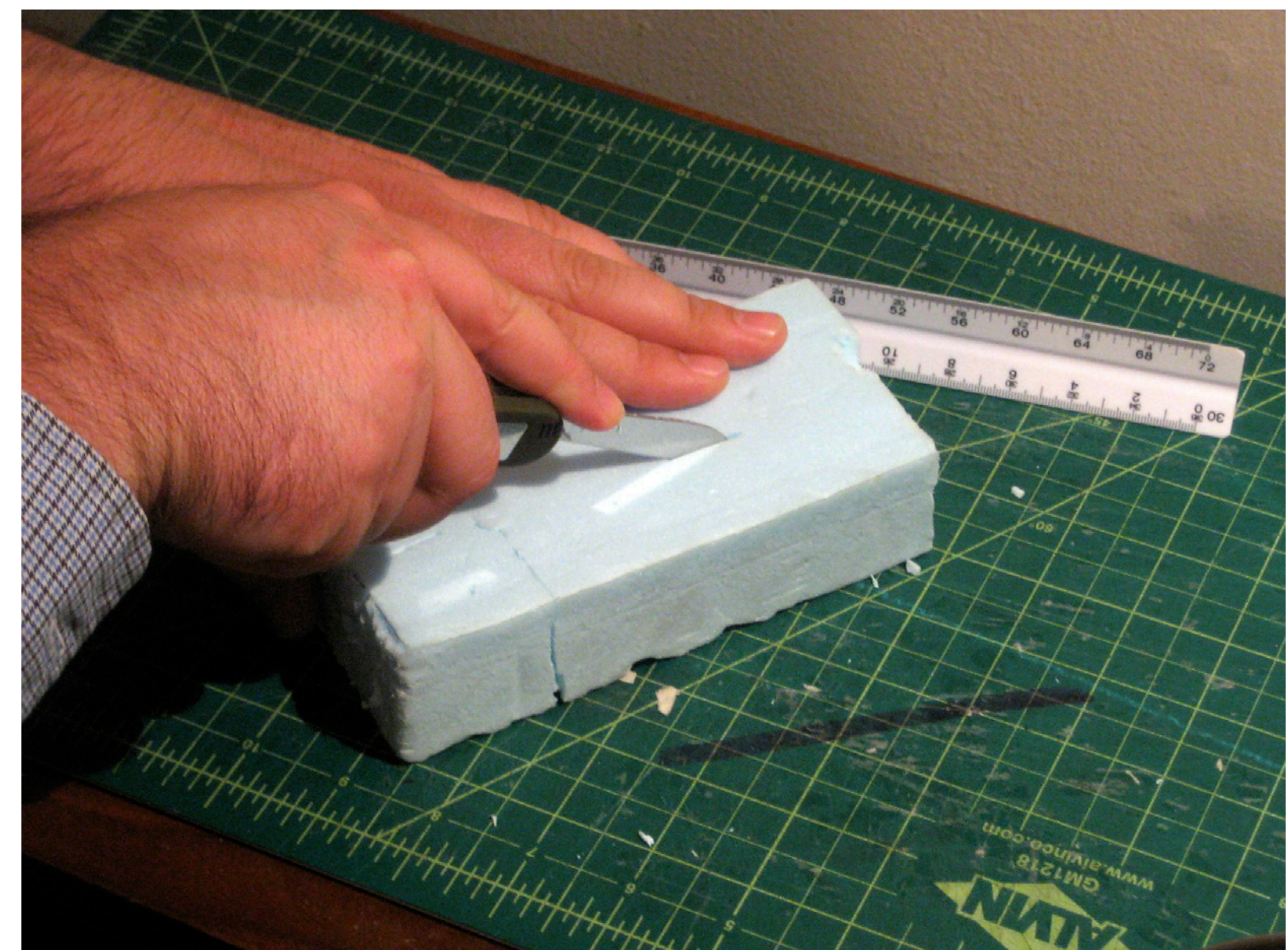

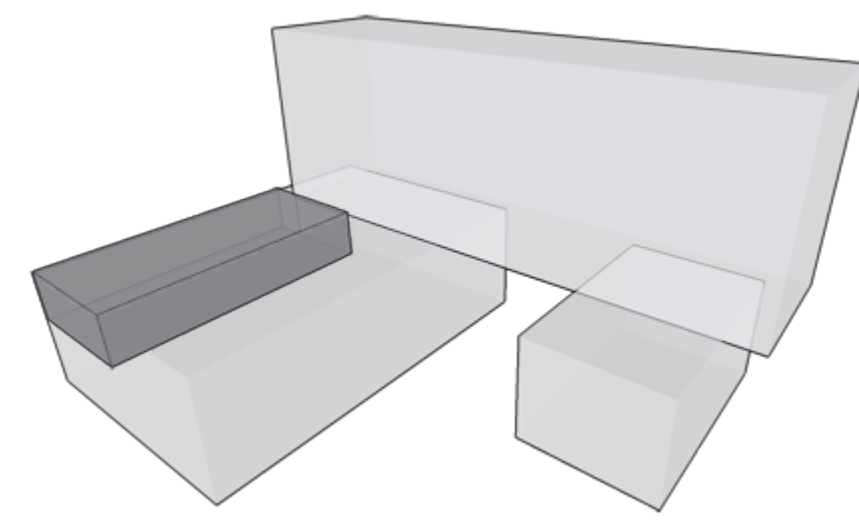

Administration

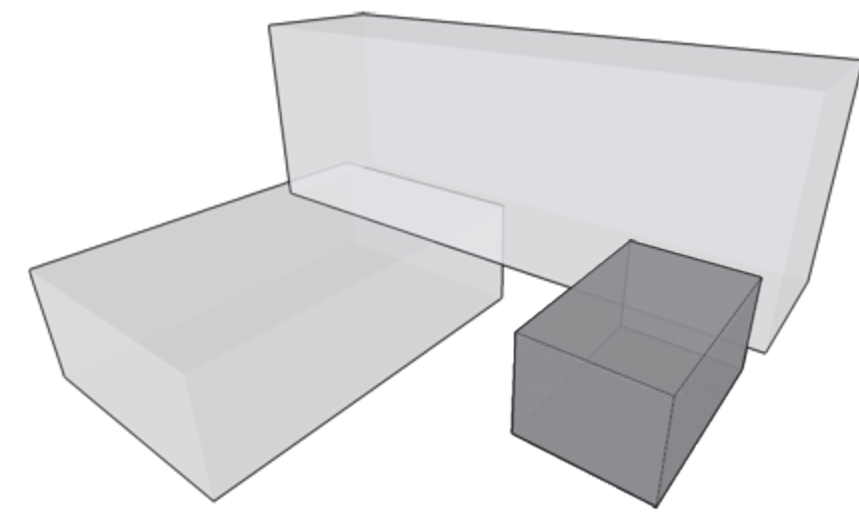

Computer labs

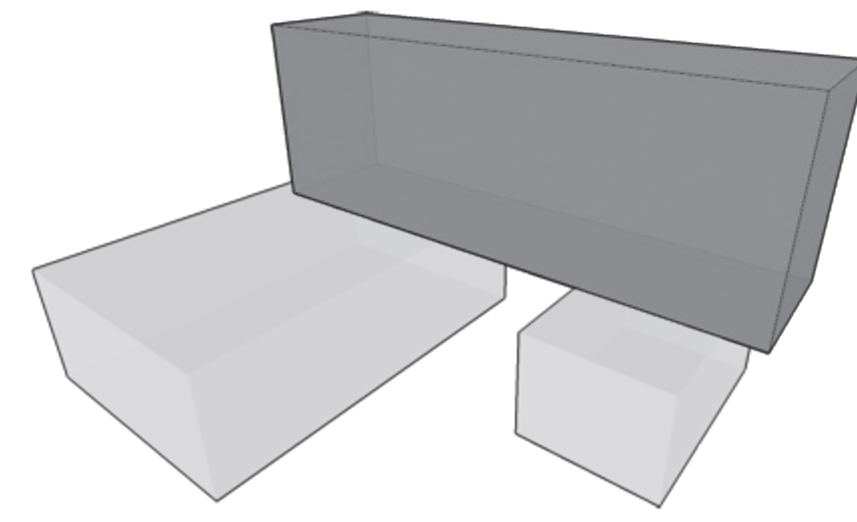

Open stacks

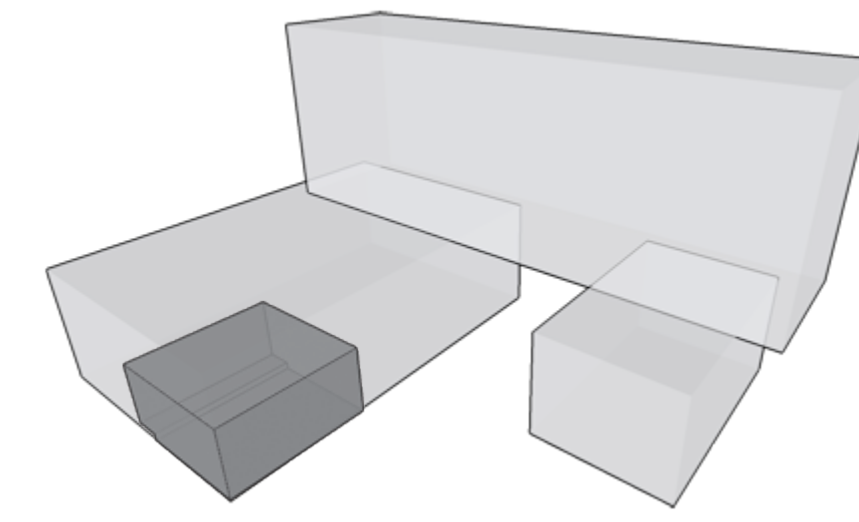

Reading room

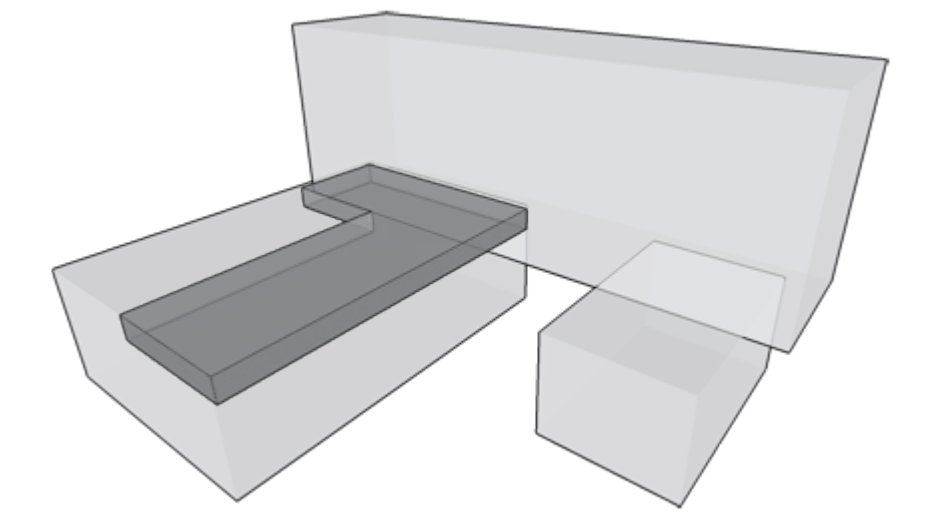

Periodicals

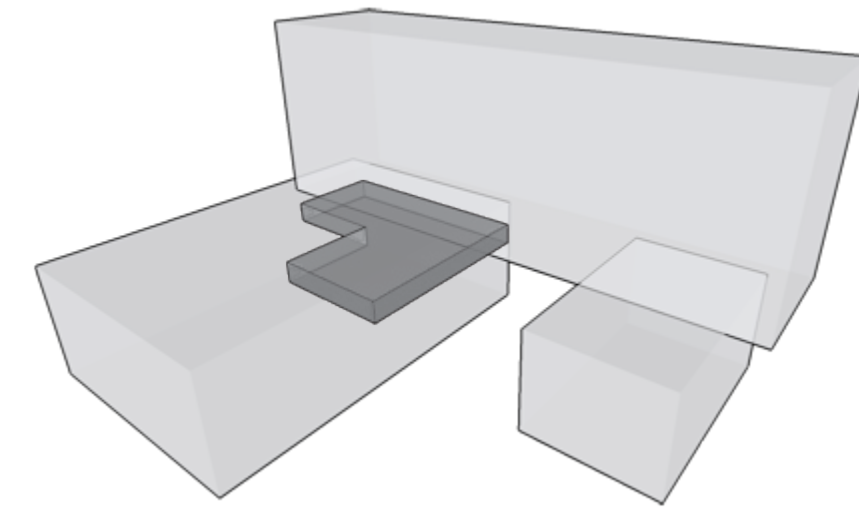

Reference

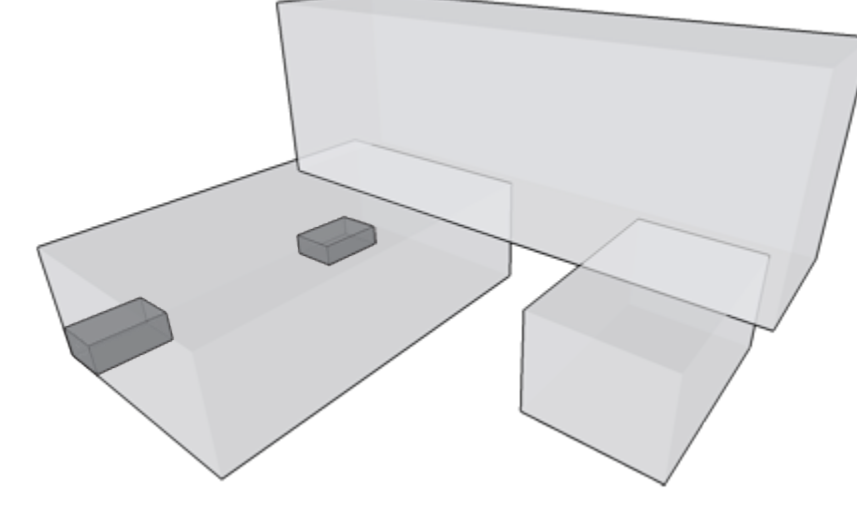

Retail

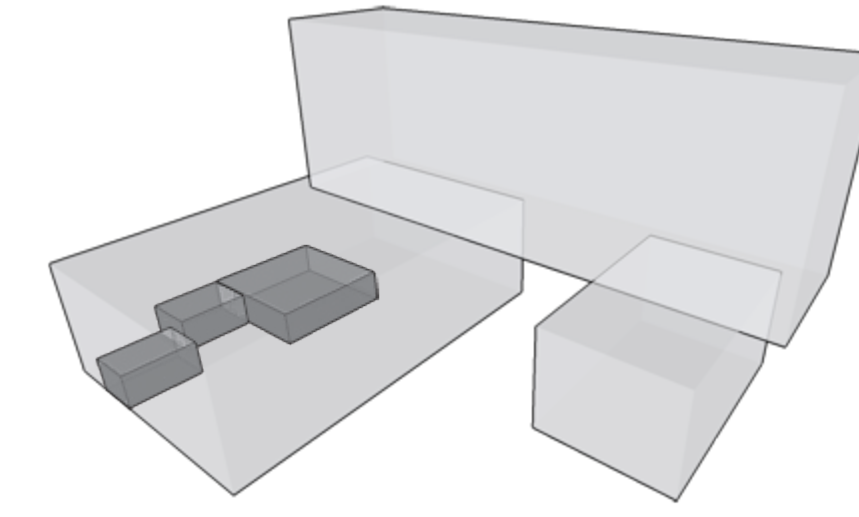

Classrooms

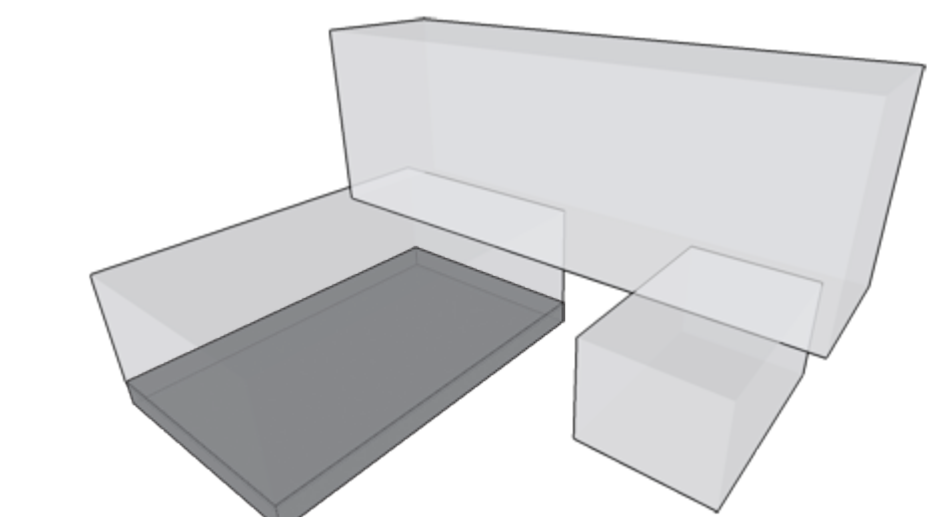

Closed stacks

Plans

1" = 20'0"

- 1 Lobby
- 2 Exhibits
- 3 Retail
- 4 Lecture hall
- 5 New books
- 6 Reading room
- 7 Classrooms
- 8 Loading
- 9 Computer labs
- 10 Reference
- 11 Reserves
- 12 Administration
- 13 Periodicals
- 14 Open stacks
- 15 Study rooms
- 16 Green roof terrace

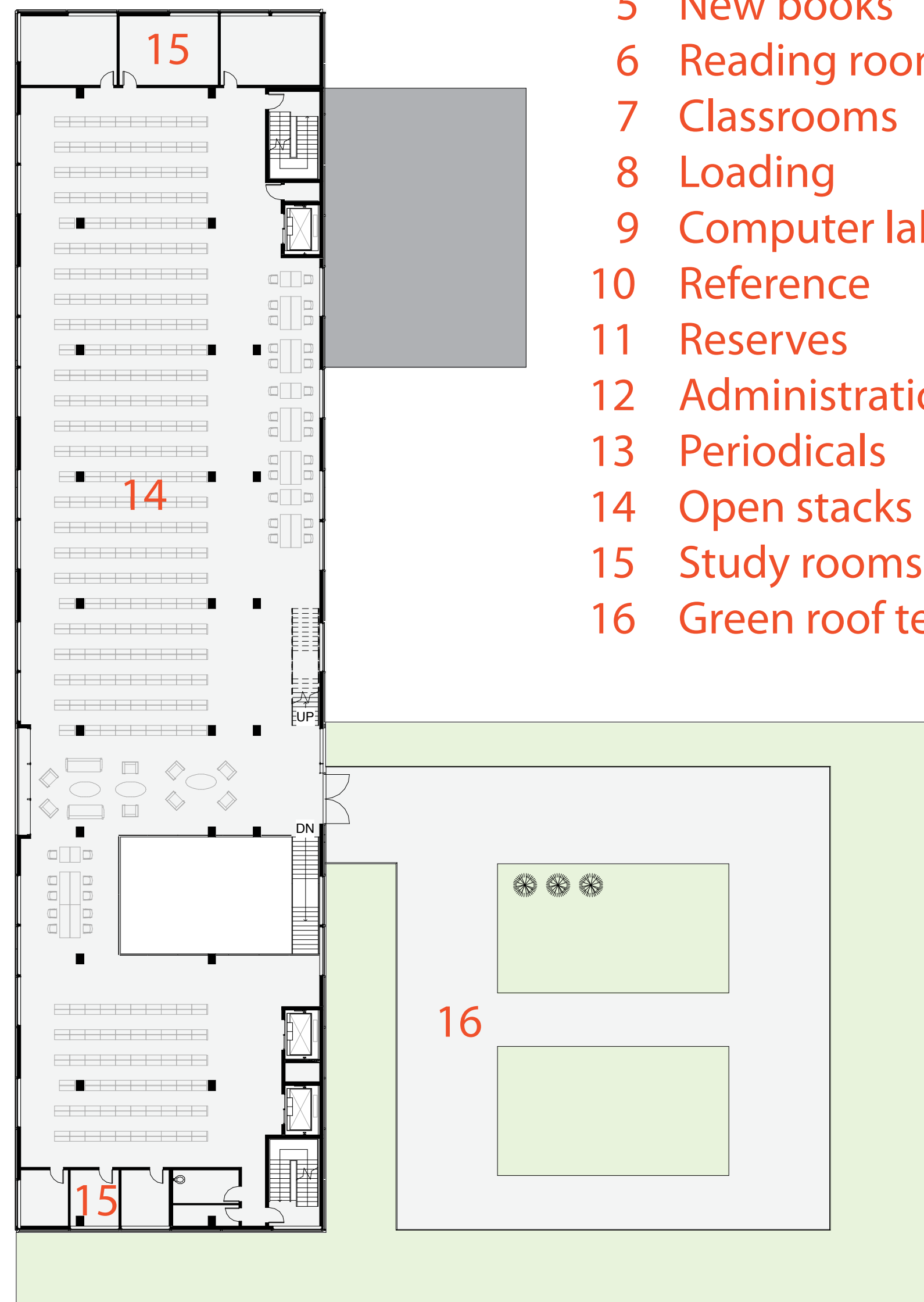

Level 4

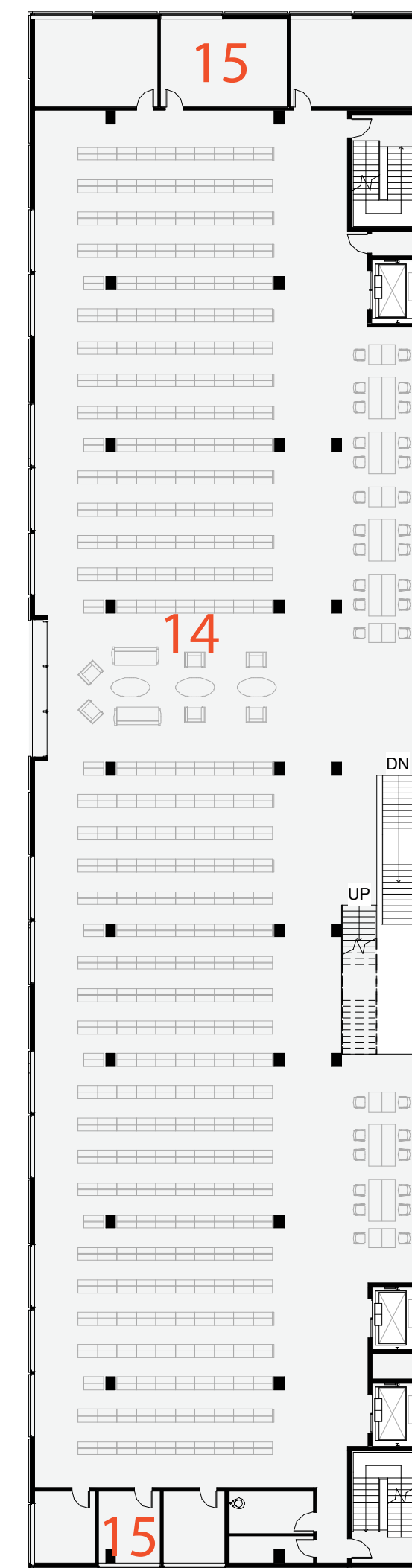

Level 5

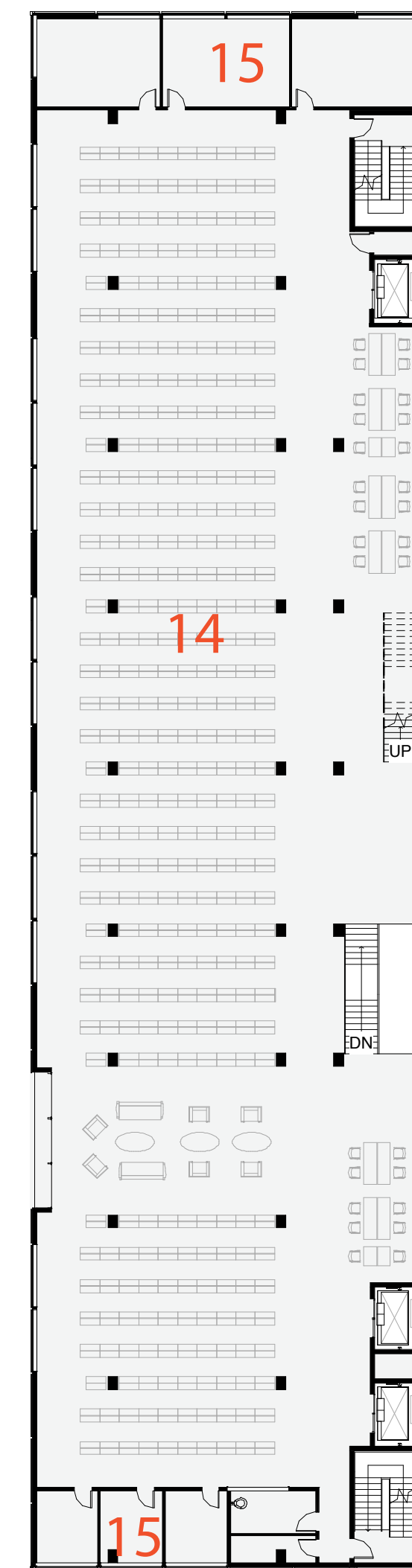

Level 6

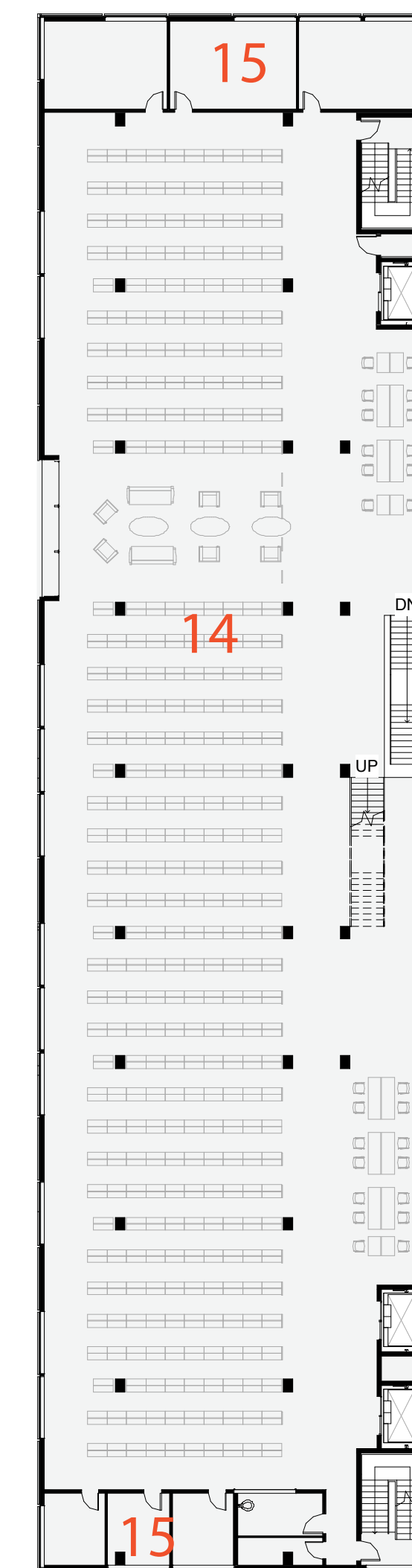

Level 7

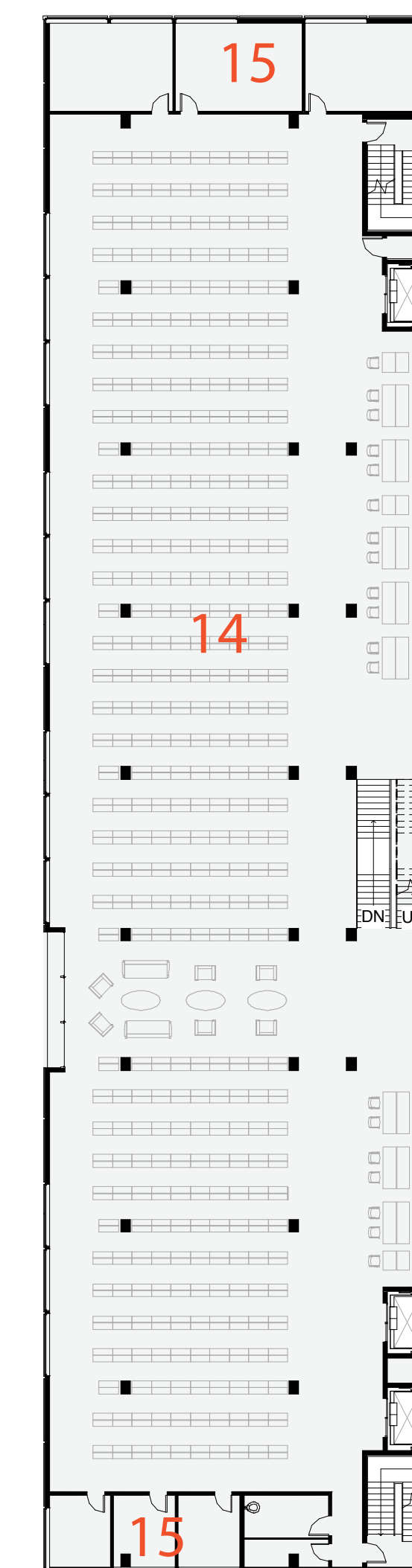

Level 8

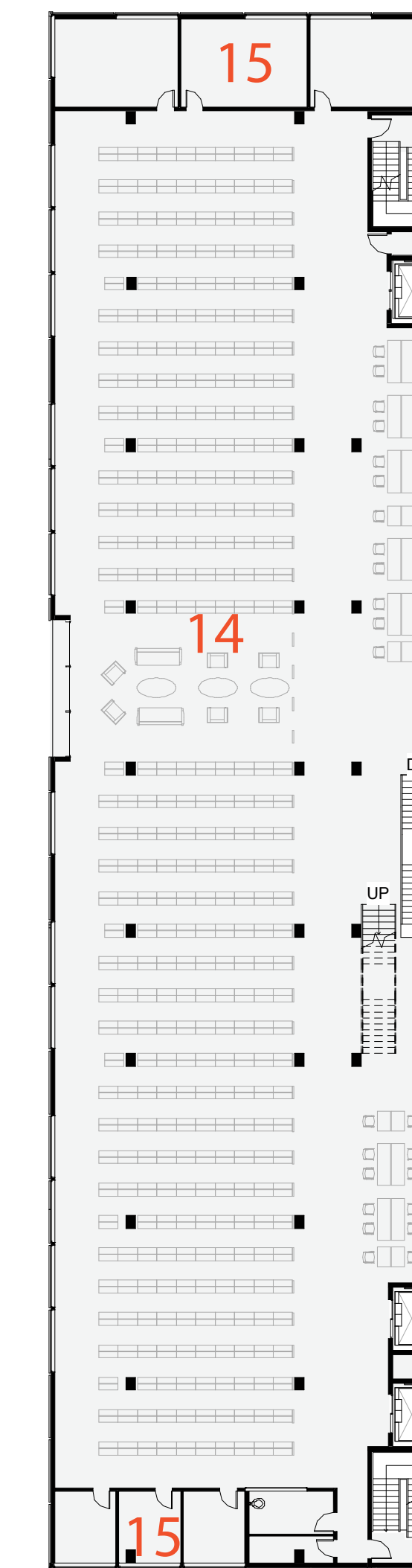

Level 9

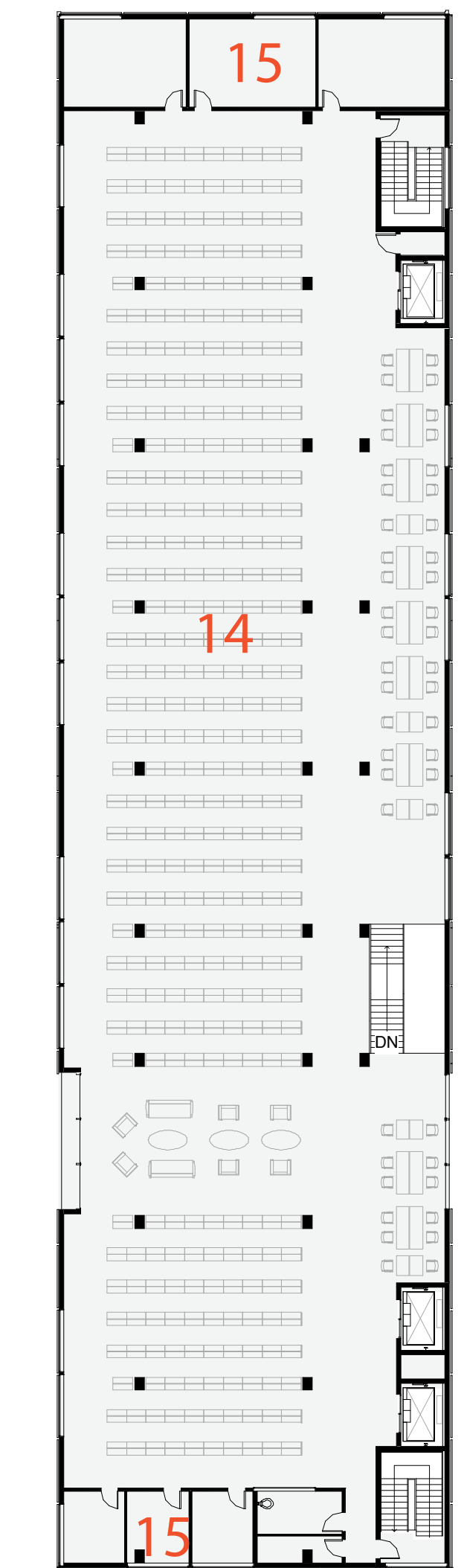

Level 10

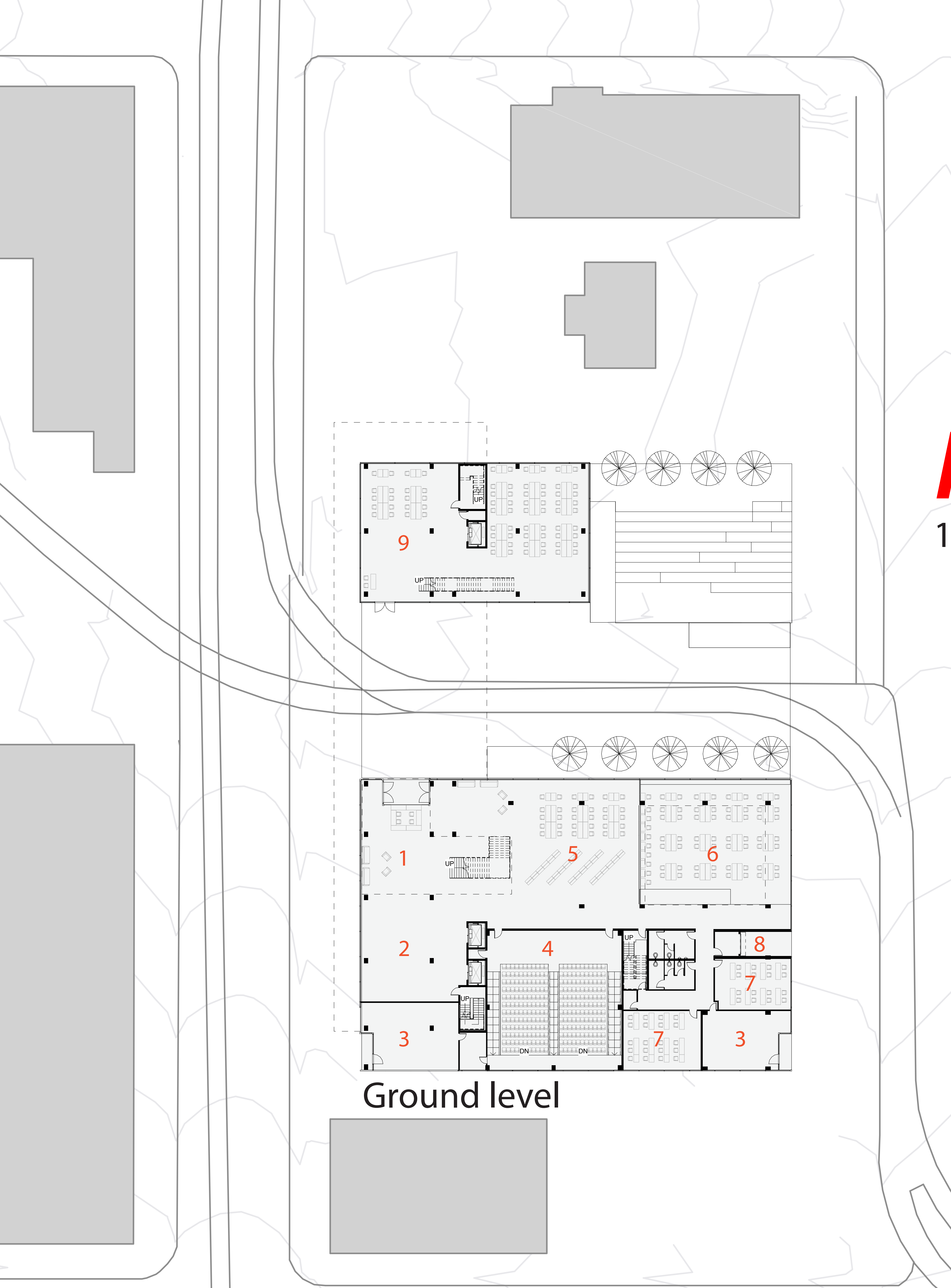

Plans

1" = 20'0"

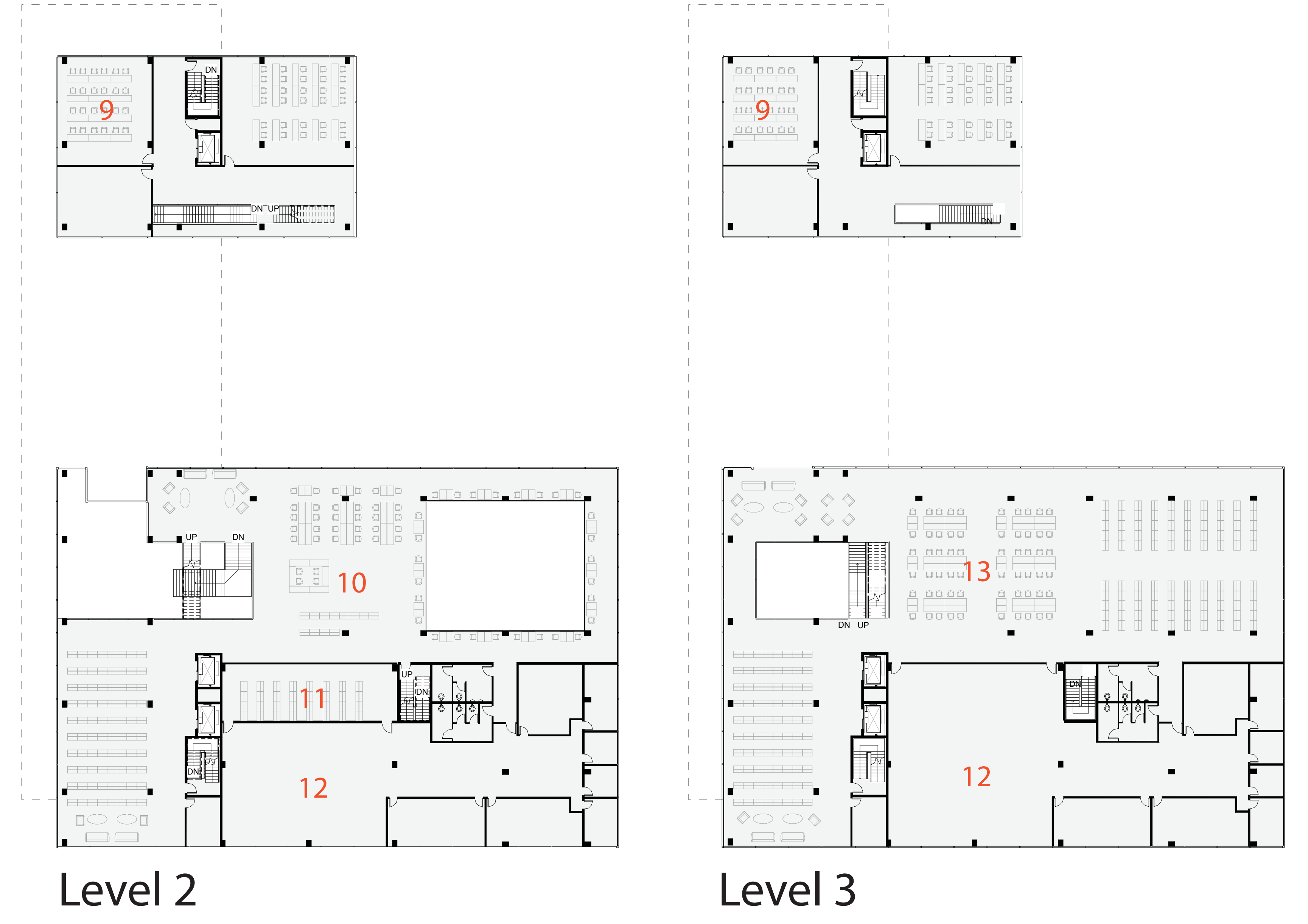
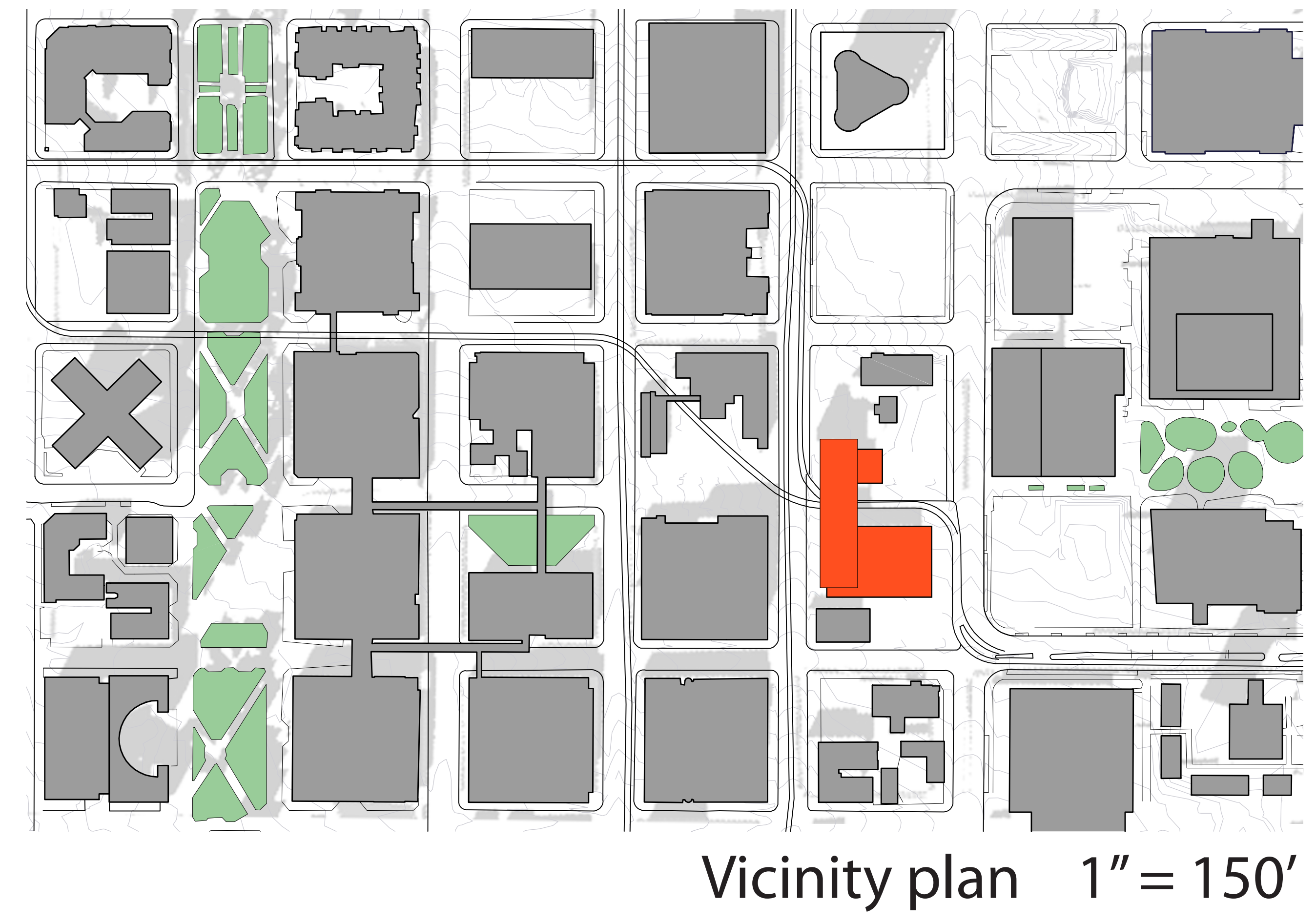

Ground level

Level 2

Level 3

Vicinity plan 1" = 150'

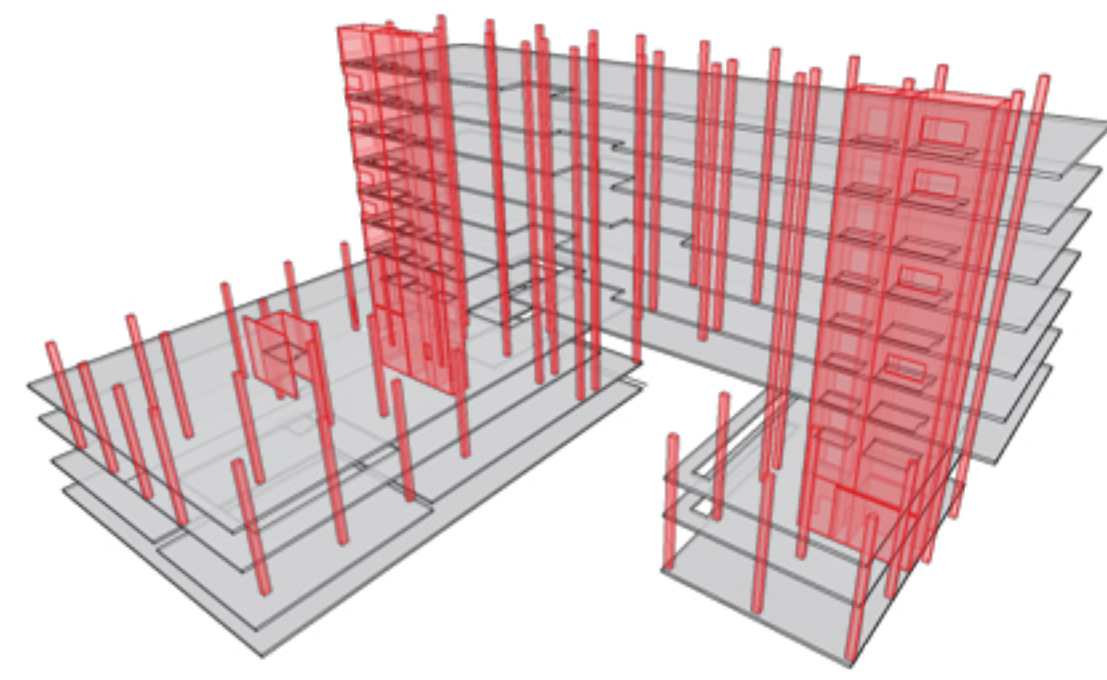

Post-tensioned concrete slabs create the library's floors and are tied into steel columns and three circulation cores which serve as shear walls. Deep concrete beams span the 60' opening.

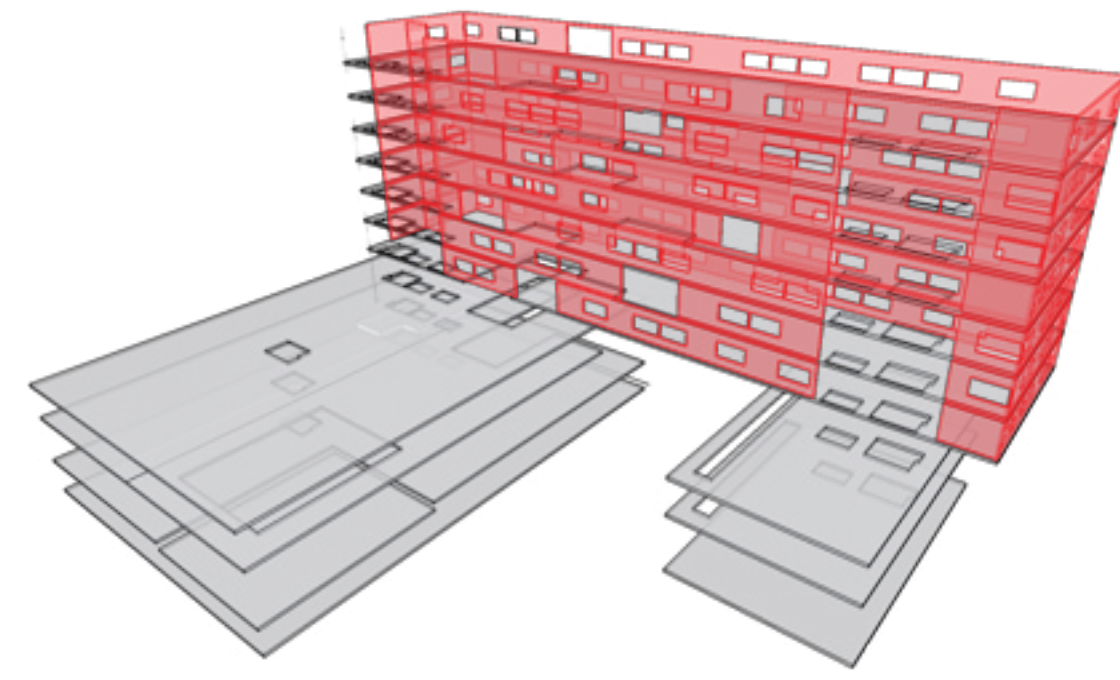

Window openings punch through light gauge steel walls in the upper floors. Wall assembly has exterior rigid insulation and is clad with metal panels. The window-wall ratio of about 50% permits daylighting on a relatively narrow floor plate of 60' while still protecting book stacks to the interior. High performance double glazed windows with low-E ratings prevent solar gain.

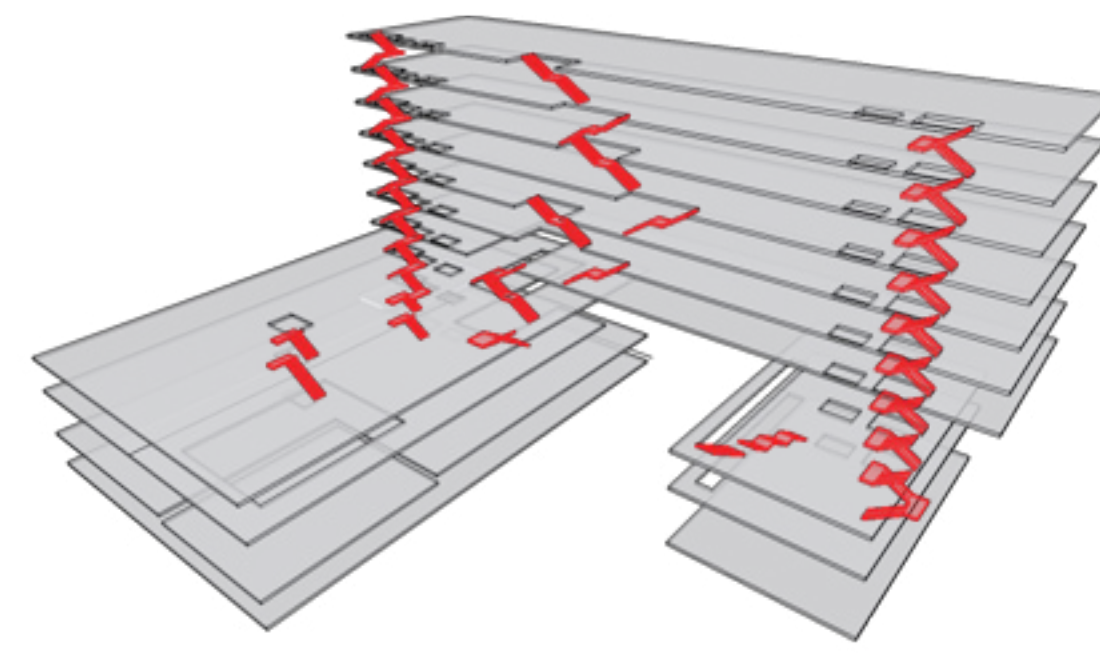

Irregular vertical circulation on the east side permits visual access between floors and connects the lower building to the upper through a four-story atrium. The feature stairs allow casual browsing of stacks between floors without relying on the elevators.

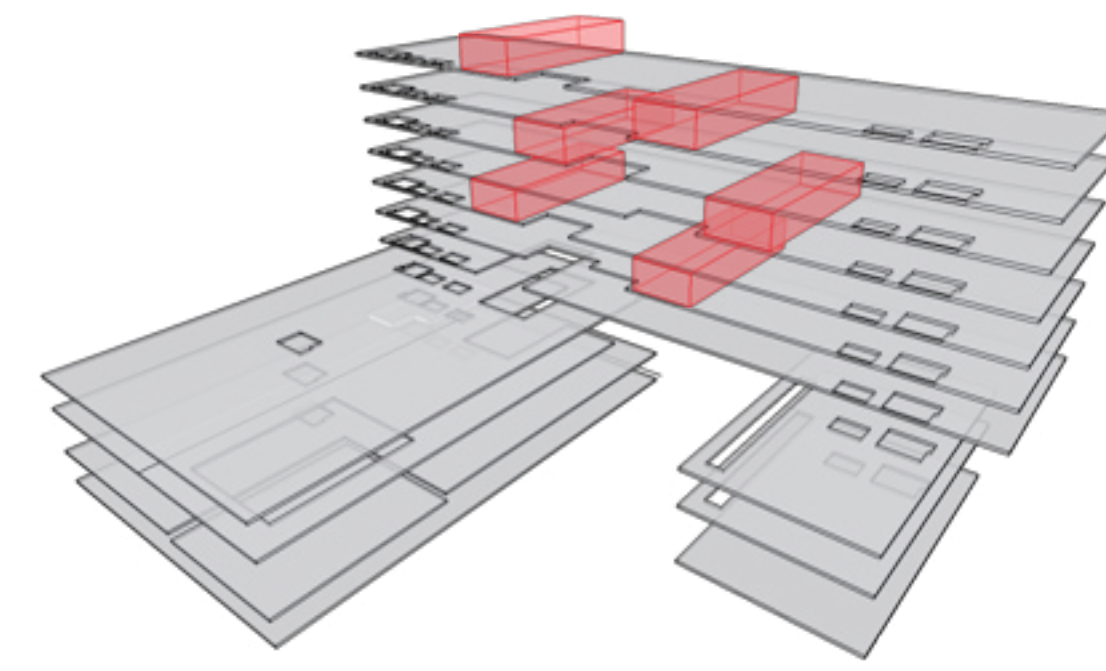

Stair landings at each floor create view windows which puncture the east and west façades, breaking up the slot window pattern and providing large gathering and study areas on each floor.

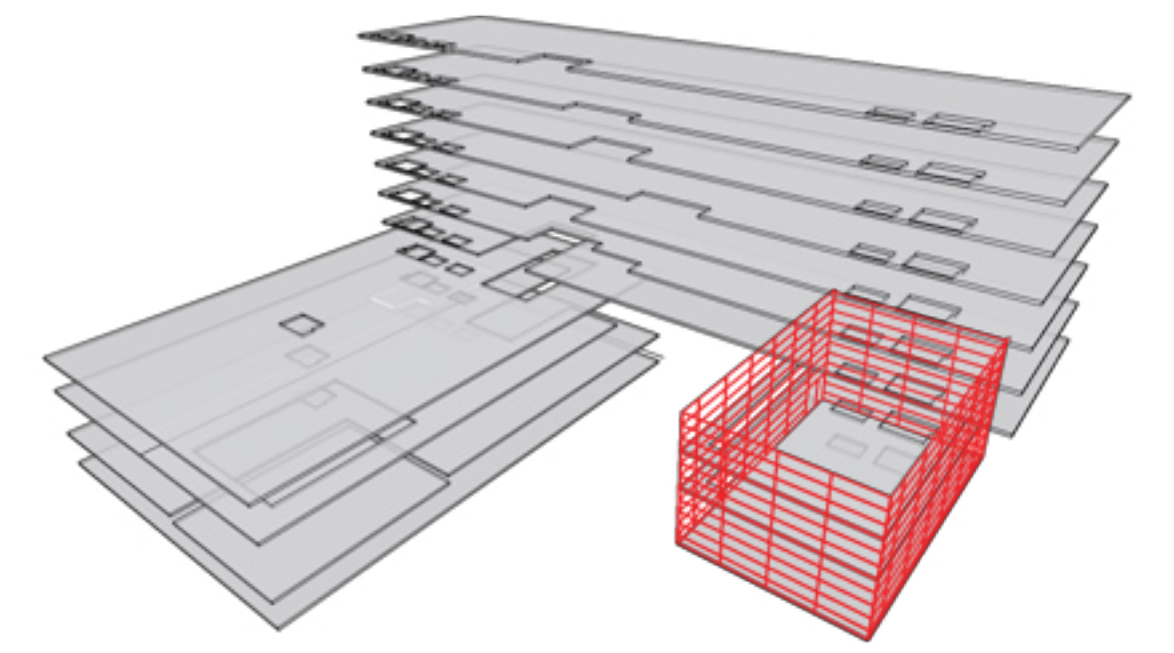

The 24-hour computer labs and digital media training rooms are clad in a metal mesh which reduces glare on screens and creates an introverted space for focused computer use.

Sections



Cross section looking south
1" = 16'0"



Longitudinal section looking west 1" = 10'0"



Portland State University Library

*Ted
Mitchner*

*ARCH 586
Holst Architecture
June 3, 2010
University of
Oregon*



