

**HISTORIC RESOURCE SURVEY FORM**  
University of Oregon Cultural Resources Survey  
Eugene, Lane County, Oregon  
Summer 2006

**RESOURCE IDENTIFICATION**

Current building name: Condon Hall

Historic building name: Science Building

Building address: 1321 Kincaid Street

Ranking: Primary

**ARCHITECTURAL DESCRIPTION**

Architectural style classification: Mediterranean Style

Building plan (footprint shape): Irregular

Number of stories: 2 on a raised basement; 3 for the 1967 addition

Foundation material(s): Concrete

Primary exterior wall material: Brick

Secondary exterior wall material: Terra cotta

Roof configuration/type: Flat (both original and addition)

Primary roof material: Unknown

Primary window type: Multi-pane horizontal pivot with special rounded-top

Primary window material: Steel

Decorative features and materials: Decorative terra cotta tile and cornices, Roman arches, pilasters, brick ornamental bands, and brick basket-weave patterns below the upper windows

Landscape features: Large deciduous tree flanks the entrance on the south. A retaining wall flanks the north end of the entrance and wraps around the corner to the north side. A sunken courtyard sits between the original structure and later addition.

Associated resources: Memorial Quad, 13<sup>th</sup> Ave Axis, Johnson Lane Axis, Chapman Hall

Comments: Condon was intended to serve as the north wing of a larger science complex but the plan was abandoned in the 1940's. A modern addition was added to Condon's south side in 1967 by the architects responsible for the adjacent Prince Lucien Campbell Hall.

**ARCHITECTURAL HISTORY**

Date of construction: 1925

Architect: Lawrence and Holford; Chief Designer, Ellis Lawrence

Builder/Contractor: Trancell and Parelius; Alaska Plumbing and Heating Co.; Rushlight, Hastorf, Lord (Plumbing); Morrison Electric Co.

Moved? (yes/no): No      Date of move(s): n/a

Description/dates of major additions/alterations: 1954: interior renovated; 1967: interior alterations, south addition (Stanton, Boles, Maguire and Church); 1975: replacement of west fire escape w/ stair tower, entrance landscape changed; 1978: correction of safety code deficiencies; 2000: remodel of rooms 105, 160, 206, 207; 2001: remodel of Infographics Office and room 204

**HISTORICAL ASSOCIATIONS & SIGNIFICANCE**

Original use(s) or function(s): Educational

Current use(s) or function(s): Educational

Area(s) of significance: Education and Architecture

Period of significance: 1925

Statement of Significance (use continuation sheet if necessary):

Built in the Mediterranean style, Condon Hall was designed by Ellis Lawrence. The original portion is a two-story brick building with a rectangular footprint. From the main east entry, terra cotta tiles create a Roman arch that is supported by pilasters. The carved wood, metal and glass door, surrounding pilasters and arch emphasize the center projecting bay and symmetrical rhythm. Ornamental brick bands below the cornice and elaborate terra cotta tiles on top of the parapet frame a terra cotta cornice. Brick patterns, including basket-weave motif, accent the upper windows. An addition, completed in 1967, is connected to the south side of the building and is set back from Memorial Quadrangle. The International Style addition is a three-story building with an irregular footprint. The horizontal bands of windows are set within a concrete frame emphasizing its International stylistic characteristics. A sunken courtyard with a ramp in front of the south addition and to the south of the original structure provides a universally accessible route.

Condon Hall was named for Thomas Condon, famed Oregon geologist and one of the University's first professors. It originally housed the departments of geology, geography, and psychology. Additionally, it was also the temporary home to part of the U of O library until Knight Library was built. Today, Condon houses Geography, Anthropology, and Environmental Science departments. Condon Hall was originally intended as the north wing of a larger building that would house the science department. This plan was abandoned in the 1940's, and the 1967 south addition did not utilize the brick knock-out panel that Lawrence provided. This addition is stylistically similar to the adjacent Prince Lucien Campbell Hall and was designed by the same architectural firm. In stark contrast to the stylistic characteristics of the original building, an exterior, semi-enclosed stairway replaced the original fire escape in 1974.

Condon Hall is an architecturally distinctive work, one of six Ellis Lawrence designed buildings on the main University quadrangle, known as Memorial Quadrangle (includes Condon Hall, Knight Library, Jordan Schnitzer Museum of Art, Chapman Hall, Peterson Hall and Gilbert Hall). So, not only was Condon designed by a significant Oregon architect and a man important to campus planning and the history of the architecture program at the U of O, the building is located in a place crucial to the story of the campus' development under Lawrence. That is, it is an integral member of an ensemble of buildings referred to as one of Lawrence's greatest works. Condon Hall is in good condition and has good integrity. The south addition and western fire escape alteration do not detract from Condon's presence in the Memorial Quadrangle. Because of its significant connection to Ellis Lawrence and its contribution to the integrity of Memorial Quadrangle, Condon Hall is eligible individually for the National Register and is ranked as a primary resource.

**NATIONAL REGISTER ELIGIBILITY ASSESSMENT**Historic Significance (check one):  High  Medium  Low  Very Low or NoneIntegrity (check one):  Excellent  Good  Fair  PoorCondition (check one):  Excellent  Good  Fair  PoorBuilding designation:  City Landmark  National Register  National Historic Landmark  Not listedPreliminary National Register eligibility findingsBuilding is potentially eligible:  Individually or  As a contributing resource in a district only

If eligible individually, applicable criteria (check all that apply):

 A. Associated with significant events C. Distinctive architecturally B. Associated with significant persons D. Archaeologically importantIf applicable, building qualifies under NR Criterion Considerations:  Yes  No If yes, which apply:Building is NOT eligible:  Intact but lacks distinction or  Altered/loss of integrity or  Not 50 years old

**DOCUMENTATION**

Indicate resources consulted when researching this building (check all that apply):

- |                                                         |                                                   |                                                            |
|---------------------------------------------------------|---------------------------------------------------|------------------------------------------------------------|
| <input checked="" type="checkbox"/> University archives | <input type="checkbox"/> UO Planning Office files | <input checked="" type="checkbox"/> Newspapers             |
| <input type="checkbox"/> Sanborn maps                   | <input type="checkbox"/> Building permits         | <input type="checkbox"/> SHPO files                        |
| <input type="checkbox"/> State Archives                 | <input type="checkbox"/> State Library            | <input type="checkbox"/> State Historic Society            |
| <input type="checkbox"/> Local Historic Society         | <input type="checkbox"/> Personal interviews      | <input checked="" type="checkbox"/> Historic photographs   |
| <input type="checkbox"/> Biographical encyclopedias     | <input type="checkbox"/> Obituary indexes         | <input checked="" type="checkbox"/> Other <u>see below</u> |

**BIBLIOGRAPHICAL REFERENCES**

Lakin, Kimberly and Michael Shellenbarger, directors. Ellis Lawrence Building Survey. Salem: State Historic Preservation Office, 1989.

Teague, Ed. University of Oregon Libraries website. The Architecture of the University of Oregon: A History, Bibliography, and Research Guide, <http://libweb.uoregon.edu/guides/architecture/oregon/condon.html>.

Campus Maps, UO Info Graphics lab, <http://geography.uoregon.edu/infographics/campusMaps/LineArtMap.pdf>.

Historical Campus Map Buildout animation, UO Info Graphics Lab,  
[http://geography.uoregon.edu/infographics/projects/campus\\_Mapping.htm#](http://geography.uoregon.edu/infographics/projects/campus_Mapping.htm#)

"Dedication of Condon Hall." *Old Oregon* 8 no.5 (Feb. 1926): 8-9, 31.

"Science Building Dedication Pays Tribute to Name of Dr. Condon." *Oregon Daily Emerald* 02/09/1926, 1.

Condon Hall blueprints and building plans, Facilities Services hanging files.

**RECORDING INFORMATION**

Researched: Sarah Helwick and Erica Steverson, 02/18/06

Recorded: Susan Johnson and University Planning Office, Summer 2006

Photo number or name: Condon -- East view with later addition

**PHOTOGRAPH**



(see Continuation Sheet 1 for additional photos of this building)

**SITE PLAN**

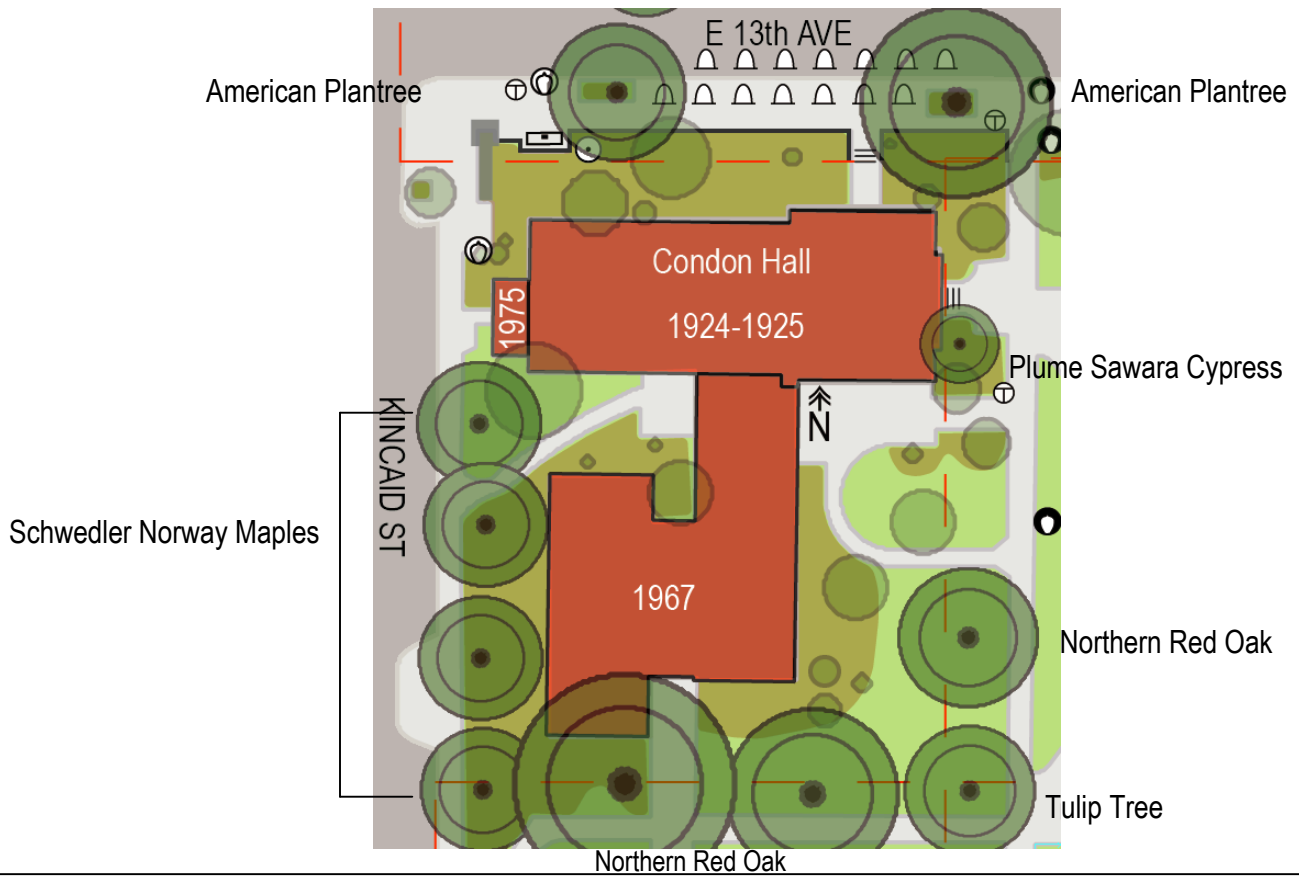

**HISTORIC RESOURCE SURVEY FORM**

University of Oregon Cultural Resources Survey  
Eugene, Lane County, Oregon  
Spring 2006

**Continuation Sheet 1**

Section          Photos          Page 4



**Figure 1. Condon Hall, Main Entry (east facade)**